



## Expanse



Serial #: 1JSREBBH5P1CB8092  
Model: 21B EXPANSE MHB  
VIN#: 1FDRU8UG3NKA69452  
Model Year: 2023 Dealer Name: National Indoor Rv Centers  
1205 Bridgestone Parkway  
La Vergne, TN 37086  
USA

## Manufacturer's Suggested Retail Price \$193,050.00

TOTAL AMOUNT DOES NOT INCLUDE STATE AND LOCAL TAXES OR LICENSE FEES. THE PRICE SHOWN ABOVE MAY OR MAY NOT BE REPRESENTATIVE OF THE ACTUAL SELLING PRICE OF SIMILAR RECREATIONAL VEHICLES IN YOUR AREA.

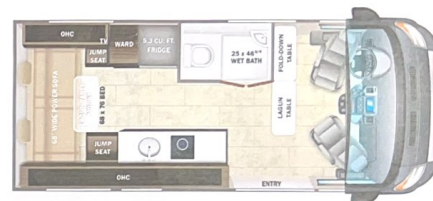

### Standard Equipment

THE FOLLOWING ITEMS ARE STANDARD ON THIS MODEL  
AT NO EXTRA CHARGE

- STANDARD DRIVING EQUIPMENT
  - For® Transit AWD 350HD
  - 141 in. wheelbase
  - GVWR - 11,000 lb.
  - GVWt - 13,000 lb.
  - 3.5L EcoBoost V6 310 HP engine with 400 ft-lb. torque
  - 10-speed transmission
  - 3.73 limited slip axle
  - 250 amp alternator
  - Aluminum wheels
  - Daytime running headlamps
  - SCS Post Crash Alert System™
  - Rear-view camera with trailer hitch assist
  - Advance trac® with RSC® (Roll Stability Control)
  - Self-wind stabilization
  - Hill start assist
  - 360° camera
  - Blind spot assist
  - Sole sensing system
  - Reverse sensing system
  - 200/75R16C BSW all-season tires
  - Tire pressure monitoring system
  - Intelligent adaptive cruise control
  - Keyless entry pad
  - Heavy-duty trailer tow package with dual 47 pin connector
  - (2) 12V AGM chassis batteries (70 amp-hr)
  - 25 gal. fuel tank (gal)
  - 12 in. SYNC 4 HDNAVIACC multi-function display
  - Power windows and door locks
  - A/C and cruise control
  - Backup camera
  - Cab area privacy shade
  - Remote keyless entry

- STANDARD EXTERIOR EQUIPMENT
  - Fiberglass running boards for cab and entry doors
  - Onan® 2,800W generator with auto-gen start
  - 1000W inverter
  - 30 amp electrical service with detachable power cord
  - (2) 12V AGM house batteries
  - House battery disconnect switch
  - (2) 110V exterior outlets
  - 190W roof mounted GoPower® solar panel with integrated control panel
  - Portable solar plug
  - Heated gray holding tank (12V pad)
  - Winterization drain system
  - Black tank flush
  - 12V demand water pump
  - Water filtration system
  - LED-lit holding tank valves
  - Outside shower

### Optional Equipment

OPTIONAL EQUIPMENT INSTALLED ON THIS VEHICLE  
BY MANUFACTURER

Base price	175,050.00
Crown Point	n/c
USA Standards	n/c
Customer Value Package	18,000.00

- STANDARD INTERIOR EQUIPMENT
  - Custom-molded, ABS interior wall panels
  - Side screen door with magnetic and zipper close offs
  - 13,500 BTU Coleman® Mach® 10 air conditioner
  - Soft-touch vinyl ceiling
  - High-intensity LED ceiling lights
  - Technomold® European-style, high-gloss cabinetry
  - Ball-bearing drawer guides
  - Residential vinyl flooring
  - Firefly Multiplex system
  - Sliding vented windows
  - Rear screen door with roll-up and black-out capabilities
  - Removable privacy shade for sliding door window
  - Powered roof vent in living area
  - 24 in. LED HD Smart TV
  - Cable TV hookup with RG-6 coax
  - Lagun table with fold-down work station
  - 1-burner induction cooktop
  - Convection microwave
  - Stainless steel sink
  - Solid-surface kitchen countertop
  - Pop-up 110V/USB outlet in kitchen
  - Power sofa converts to 68 in. x 76 in. bed
  - Shower with magnetic curtain surround
  - Aqua View® SHOWERMISER™ water management system
  - Toilet with foot flush
  - Medicine cabinet with mirror
  - Powered roof vent in bathroom

- CUSTOMER VALUE PACKAGE
  - 5.2 DRIVE™ Helwig® helper springs
  - Carefree® armless motion sensing patio awning with LED light strip
  - Timberline hydronic heating system
  - 4-way swivel driver and passenger seats
  - Winégard® Connect 2.0 4G/Wi-Fi/digital TV antenna

UNIT TOTAL 193,050.00

DEALER INSTALLED OPTIONS

### DIMENSIONS

Exterior height:.....120.00"  
Exterior width:.....82.00"

### CAPACITIES

Fresh water tank (gals.):.....24.00  
Gray water tank (gals.):.....15.75  
Black water/toilet tank (gals.):.....15.50  
Propane (lbs.):.....0  
Propane (gals.):.....0  
Water heater (gals.):.....0.00

### TIRES

Tire size (front):.....205/75R16C  
Tire size (mid):.....  
Tire size (rear):.....205/75R16C

\*\*\*Some dimensions may be rounded and may vary from the actual dimensions\*\*\*

\*\*\*Weights may be estimated calculations and may vary from the actual weight

- refer to the vehicle weight labels for actual weights\*\*\*

Floorplans, features and specifications are subject to change without notice.