



Launch

Serial #: 1JSPEBBH8P1SY8209
Model: 19Y LAUNCH MHB
VIN#: W1W4EBVY4NT108130
Model Year: 2023 Dealer Name: National Indoor Rv Centers
100 Aubrey Drive
Lebanon, TN 37090
USA



Standard Equipment

THE FOLLOWING ITEMS ARE STANDARD ON THIS MODEL
AT NO EXTRA CHARGE

STANDARD EXTERIOR EQUIPMENT

- Mercedes-Benz Sprinter 2500 4x4 van with 144 in. wheelbase
- GVWR- 9,050 lb.
- GCWR- 13,900 lb.
- 3.0L V6 engine with 188HP and 325 ft.-lb. torque
- 7 speed automatic transmission
- 220 amp alternator
- Daytime running headlights
- Power folding heated side-view mirrors
- 5,000 lb. rear hitch receiver with 7 pin connector
- 12V chassis battery
- 24.5 gal. fuel tank (diesel)
- 5.8 gal DEF Tank
- 48V 210 amp hour smart lithium battery providing 10KW hours of power
- 3,500W inverter
- 2nd 48V alternator dedicated to lithium battery
- 30 amp electrical service with detachable power cord
- 200W of roof-mounted solar panels
- Slow charge solar panel for chassis battery
- Utility center with water controls and outside hose
- City water connection
- Winterization drain system
- 12V demand water pump
- Water filtration system
- House battery disconnect switch
- Aqua View® SHOWERMETER™ water management system
- Heated grey tank (12V pad) with skid plate
- Interior-mounted fresh water tank
- LED light running boards for cab and entry doors
- 110V exterior outlet
- Portable solar plug
- LED light holding tank valves
- Side screen door with magnetic and zipper close off
- Rear screen door with roll-up and black out capabilities
- Fold-down exterior table
- On-board air compressor with front and rear chucks
- Remote keyless entry

CUSTOMER VALUE PACKAGE

- E-Z DRIVE™ Konig shocks, heavy-duty rear stabilizer bar
- Carefree® amies patio awning with LED light strip and wind sensor
- Double roof rack and movable roof ladder
- Front and rear wind deflectors with front LED light bar
- Hydronic heating system with LED touchscreen control
- 48V Coleman® Mach® 10 air conditioner
- Black aluminum wheels with BFGoodrich® All-Terrain T/A® KO2® tires

Optional Equipment

OPTIONAL EQUIPMENT INSTALLED ON THIS VEHICLE
BY MANUFACTURER

STANDARD INTERIOR EQUIPMENT

- 10.25 in. MBUX infotainment center
- Power windows and door locks
- A/C and cruise control
- Active Distance Assist (DISTRONIC®)
- Active brake assist
- Heated power towel driver/passenger seats
- Smartphone tray with wireless charging
- Rain-sensing wiper system
- Lane keeping assist
- Blind spot assist
- Traffic sign assist
- Leather-wrapped tilt steering wheel with integrated controls
- Cab area privacy shade
- Softflex® interior wall panels
- Soft-touch vinyl ceiling
- High-intensity LED ceiling lights
- Technoform® European-style cabinetry
- Technoform® pull-out kitchen countertop extension
- Pantry with Technoform® pull-out extension
- Durable rubber flooring
- Finley Multiplex system
- (2) sliding vented windows
- Removable privacy shade for sliding door window
- Rear dual-pane acrylic window with cassette shades
- Maxxair® Deluxe roof vent
- (2) additional cab bucket seats with slide and recline features
- Collapsible dinette table
- 3 cu ft. DC refrigerator
- Portable induction cooktop
- Stainless steel sink
- 110V/USB outlets throughout
- Drop-down overhead bed with 750 lb. capacity
- Fiberglass side pods create larger sleeping surface
- Rear garage under bed with L-track mounts for securing cargo
- (2) recessed under-bed storage bags
- All-in-one wet bath with shower and cassette toilet
- Removable bamboo shelf in wet bath
- Powered roof vent in bathroom
- Retractable clothes line in shower
- Seatbelts in all seating locations
- Driver and passenger airbags
- Smoke alarm
- Carbon monoxide detector
- Fire extinguisher

UNIT TOTAL 231,375.00

DEALER INSTALLED OPTIONS

Manufacturer's Suggested Retail Price \$231,375.00

TOTAL AMOUNT DOES NOT INCLUDE STATE AND LOCAL TAXES OR LICENSE FEES. THE PRICE SHOWN ABOVE MAY OR MAY NOT BE REPRESENTATIVE OF THE ACTUAL SELLING PRICE OF SIMILAR RECREATIONAL VEHICLES IN YOUR AREA.

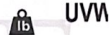
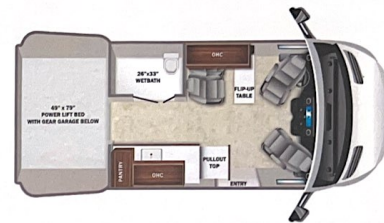

DIMENSIONS

Exterior height:.....121.00"
Exterior width:.....82.00"

CAPACITIES

Fresh water tank (gals.):...22.00
Gray water tank (gals.):...20.00
Black water/toilet tank (gals.):...4.75
Propane (lbs.):.....0
Water heater (gals.):.....0.00

TIRES

Tire size (front):.....LT245/70R17 E
Tire size (mid):.....
Tire size (rear):.....LT245/70R17 E

Some dimensions may be rounded and may vary from the actual dimensions

***Weights may be estimated calculations and may vary from the actual weight

- refer to the vehicle weight labels for actual weights ***

Floorplans, features and specifications are subject to change without notice.