



## Accolade

Serial #: 1JSNECBU3P1HM8065  
Model: 37M ACCOLADE MHC  
VIN#: 4UZADVFC5NCNS9615  
Model Year: 2023 Dealer Name: NATIONAL INDOOR RV CENTERS  
1350 HURRICANE SHOALS ROAD  
LAWRENCEVILLE, GA 30043  
USA



### Standard Equipment

THE FOLLOWING ITEMS ARE STANDARD ON THIS MODEL  
AT NO EXTRA CHARGE

**STANDARD EXTERIOR EQUIPMENT**

- Freightliner® 52RV chassis
- GVWR - 31,000 lb.
- GVWR - 43,000 lb.
- Cummins® ISB 6.7L 360 HP diesel engine with 800 R-36 torque
- Alaris® 3000 MH automatic transmission
- 185 amp alternator
- 0-rated highway tires - 275/60R22.5
- Engine exhaust brake
- 12,000 lb. hitch with 1,200 lb. tongue capacity and 7-pin plug
- Dual 12V chassis batteries
- 100 gal. fuel tank
- 10 gal. DEF tank
- Onan® 8.0kW Quiet Diesel generator and auto-gen start
- Transfer switch with reverse polarity protection
- (4) 6V AGM (220Ah) house batteries on slideout tray
- 190W solar panel with dual controller
- 30,000 BTU auto-ignition furnace
- Electric fireplace
- 24.5 gal. propane tank (33 lb.)
- LP quick-connect hookup
- ThermaSens® Sun-Con Turbo macerator system
- Exterior utility center
- Winterization drain system
- Black tank flush
- Outside shower
- 12V demand water pump
- Water filtration system
- TuffShed™ vacuum-bond laminated roof, floor and sidewalls
- Roof-foam insulation (R-24 max roof, R-9 max floor, R-5 max walls)
- One-piece, seamless, crowned fiberglass roof
- Premium Sikens full-body paint
- Automatic hydraulic leveling jacks
- Alcoa® aluminum rims
- Exterior entertainment center with outside speakers, LED HD Smart TV mounted on swivel bracket and single-disc DVD/CD/AM/FM radio
- Winnebago® In-Motion satellite dish
- Deluxe heated, remote-controlled, side-view mirrors
- Entrance door with industry's largest travel-view window
- Electric-powered entrance steps
- Slideout cover awnings
- Carpeted, full pass-through storage compartments with lockable slam latch doors
- Roof ladder
- Smoke alarm
- Carbon monoxide detector

**STANDARD INTERIOR EQUIPMENT**

- 6-way power driver and passenger seats
- Power windows and door locks
- A/C and cruise control
- Tilt steering wheel
- Auxiliary start switch
- Privacy curtains for cab area
- Custom-molded ABS surround in cab-over area
- Overhead bunk with 750 lb. capacity
- Finely Multiplex system
- High-intensity recessed LED ceiling lights
- 8 ft. n. interior ceiling height with padded vinyl ceiling
- Raised-panel hardwood cabinetry throughout
- Deluxe hidden cabinet hinges
- Ball-bearing drawer guides
- Vinyl plank flooring
- Entegra-exclusive, easy-operation legless dinette table
- LED HD Smart TV in living area
- Winegard 2.0 Wi-Fi/4G antenna
- Wood-framed kitchen window with spice cabinets
- 2-burner induction cooktop
- LED-ill. solid-surface kitchen countertops with recessed stainless steel sink and sink covers
- Flip-up countertop extension (select models)
- Shower with decorative surround, glass door, skylight and light
- Porcelain toilet with foot flush
- Recessed, LED-ill. stainless steel bathroom sink
- Powered roof vent in bathroom with wall switch
- Walk-around, king-size bed with power head lift, bedspread and nightstands
- USB port and wireless charging in nightstands
- Under-bed storage (select models)
- LED HD Smart TV in bedroom
- Large wardrobes
- Bunks with industry-exclusive 300 lb. capacity each (37L)
- Wall-mounted tablet holder in each bunk (37L)
- 2-point lap safety belts in all designated seating locations
- Third brake light

**CUSTOMER VALUE PACKAGE**

- E-Z DRIVE™ PREMIER Computer-balanced driveline, rear air suspension, heavy-duty rear stabilizer bar, full air brakes, SACHS shocks
- One-piece, seamless fiberglass front and rear caps
- Automotive-bonded panoramic window in front cap with power shade
- Dual-pane, tinted safety-glass windows
- (2) 15,000 BTU A/C units with heat pumps
- Electric patio awning with LED lights
- 2,000W pure sine wave inverter
- Power cord reel with 50 amp service
- Sony® entertainment center with Apple CarPlay® and Android Auto™
- Backup and side-view cameras
- Residential refrigerator
- Residential-size convection microwave

### Optional Equipment

OPTIONAL EQUIPMENT INSTALLED ON THIS VEHICLE  
BY MANUFACTURER

|                              |            |
|------------------------------|------------|
| Base price                   | 324,300.00 |
| Fossil                       | n/c        |
| Cobblestone Full Paint       | 30.00      |
| USA Standards                | n/c        |
| Customer Value Package       | 6,750.00   |
| Residential Refrigerator     | n/c        |
| Washer/Dryer Combo           | 1,943.00   |
| 8K Generator                 | n/c        |
| Travel Direct TV             | n/c        |
| Satellite Network            | 1,343.00   |
| Slideout Tray W/Electric     | n/c        |
| Cooler in Basement           | 1,193.00   |
| Booth Dinette                | n/c        |
| Theater Seating Sofa w/Power | n/c        |

## Manufacturer's Suggested Retail Price \$335,559.00

TOTAL AMOUNT DOES NOT INCLUDE STATE AND LOCAL TAXES OR LICENSE FEES. THE PRICE SHOWN ABOVE MAY OR MAY NOT BE REPRESENTATIVE OF THE ACTUAL SELLING PRICE OF SIMILAR RECREATIONAL VEHICLES IN YOUR AREA.

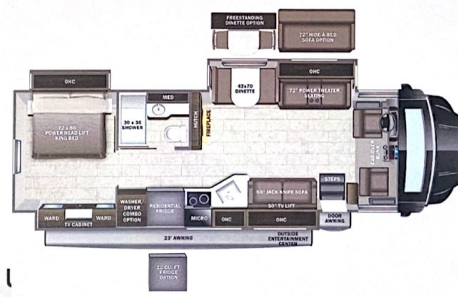

### DIMENSIONS

Exterior height:.....160.00"  
Exterior width:.....101.00"

### CAPACITIES

Fresh water tank (gals.):.....72.00  
Gray water tank (gals.):.....81.00  
Black water/toilet tank (gals.):.....50.00  
Propane (lbs.):.....83  
Propane (gals.):.....19  
Water heater (gals.):.....0.00

### TIRES

Tire size (front):.....275/80R22.5G  
Tire size (mid):.....  
Tire size (rear):.....275/80R22.5G

UNIT TOTAL 335,559.00

DEALER INSTALLED OPTIONS

\*\*\*Some dimensions may be rounded and may vary from the actual dimensions\*\*\*

\*\*\*Weights may be estimated calculations and may vary from the actual weight - refer to the vehicle weight labels for actual weights\*\*\*

Floorplans, features and specifications are subject to change without notice.