



## Launch

Serial #: 1JSPEBBH7N1SY8182  
Model: 19Y LAUNCH MHB  
VIN#: W1W4EBVY4NT088803  
Model Year: 2022 Dealer Name: National Indoor Rv Centers  
1205 Bridgestone Parkway  
La Vergne, TN 37086  
USA



### Standard Equipment

THE FOLLOWING ITEMS ARE STANDARD ON THIS MODEL  
AT NO EXTRA CHARGE

**CUSTOMER VALUE PACKAGE**  
- E-Z DRIVE™: Konrad shocks, heavy-duty rear  
slideway bar  
- Cane-free armless patio awning with LED light strip  
and wind sensor  
- Double roof rack and moveable roof ladder  
- Front and rear wind deflectors with front LED light  
bar  
- Hydronic heating system with LED touchscreen  
control  
- 48V Coleman® Mach® 10 air conditioner  
- Black aluminum wheels with BF Goodrich®  
All Terrain T/A's KO2® tires

**STANDARD EXTERIOR EQUIPMENT**  
- Mercedes-Benz® Sprinter 2500 4x4 van with  
144-in. wheelbase  
- GVWR: 9,050 lb.  
- GCWR: 13,930 lb.  
- 3.0L V6 engine with 188HP and 325 ft.-lb. torque  
- 7-speed automatic transmission  
- 220-amp alternator  
- Daytime running headlamps  
- Power folding heated side-view mirrors  
- 5,000 lb. rear hitch receiver with 7 pin connector  
- 12V chassis battery  
- 24-gal. full tank (diesel)  
- 5.8-gal DEF Tank  
- 48V, 210 amp hour smart lithium battery providing  
10kW hours of power  
- 300-watt inverter  
- 2nd 48V alternator dedicated to lithium battery  
- 30-amp electrical service with detachable power  
cord  
- 200 watts of roof-mounted solar panels  
- Slow charge solar panel for chassis battery  
- Utility center with water controls and outside hose  
- Winterization drain system  
- 12V demand water pump  
- Water filtration system  
- House battery disconnect switch  
- Aqua View® SHOWERMISER™ water management  
system  
- Heated grey tank (12V pad) with skid plate  
- Interior-mounted fresh water tank  
- LED-illuminated running boards for cab and entry doors  
- 110V exterior outlet  
- Portable solar plug  
- LED-illuminated holding tank valves  
- Side screen door with magnetic and zipper close  
ops.  
- Rear screen door with roll-up and black out  
capabilities  
- Fold-down exterior table  
- On-board air compressor with front and rear chucks  
- Remote keyless entry

**STANDARD INTERIOR EQUIPMENT**  
- 10.25-in. MBUX infotainment center  
- Power windows and door locks  
- A/C and adaptive cruise control  
- Active brake assist  
- Heated power swivel driver/passenger seats  
- Smartphone tray with wireless charging  
- Rain-sensing wiper system  
- Lane keeping assist  
- Blind spot assist  
- Traffic sign assist  
- Leather-wrapped tilt steering wheel with integrated controls  
- Cab area privacy shade  
- Soft-touch vinyl ceiling  
- High-intensity LED ceiling lights  
- Tecnoform® European-style cabinetry  
- Tecnoform® pull-out kitchen countertop extension  
- Pantry with Tecnoform® pull-out extension  
- Durable rubber flooring  
- Freshly Multiplex system  
- (2) sliding vented windows with cassette shades  
- Rear dual-pane acrylic window with cassette shades  
- MaxxAir Deluxe roof vent  
- (2) additional cab bucket seats with slide and recline  
features  
- BOSS® dual-zone radio with Bluetooth®  
- Collapsible dinette table  
- 30-LB. DC refrigerator  
- Portable induction cooktop  
- Stainless-steel sink  
- 110V/USB outlets throughout  
- Drop-down overhead bed with 750-lb. capacity  
- Fiberglass slide pods create larger sleeping surface  
- Rear giraffe under bed with L-track mounts for securing  
cargo  
- (2) recessed under-bed storage bags  
- All-in-one wet bath with shower and cassette toilet  
- Removable bamboo shelves in wet bath  
- Powered roof vent in bathroom  
- Retractable clothes line in shower  
- Seatbelts in all seating locations  
- Driver and passenger airbags  
- Smoke alarm  
- Carbon monoxide detector  
- Fire extinguisher

### Optional Equipment

OPTIONAL EQUIPMENT INSTALLED ON THIS VEHICLE  
BY MANUFACTURER

Base price	201,000.00
Serenity	n/c
Standard Exterior	n/c
USA Standards	n/c
22 SPR WINDOW 4X4	n/c
SANDSTONE USA 2500 9050	n/c
144" 3.0L DSL NB05	n/c
Customer Value Package	19,125.00

UNIT TOTAL 220,125.00

DEALER INSTALLED OPTIONS

## Manufacturer's Suggested Retail Price \$220,125.00

TOTAL AMOUNT DOES NOT INCLUDE STATE AND LOCAL TAXES OR LICENSE FEES. THE PRICE SHOWN ABOVE MAY OR MAY NOT  
BE REPRESENTATIVE OF THE ACTUAL SELLING PRICE OF SIMILAR RECREATIONAL VEHICLES IN YOUR AREA

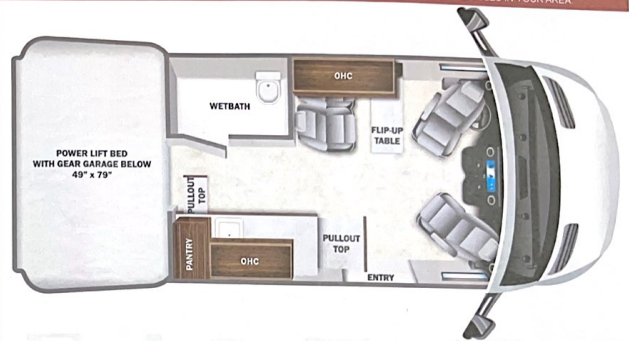

### DIMENSIONS

Exterior height:.....121.00"  
Exterior width:.....82.00"

### CAPACITIES

Fresh water tank (gals.).....22.00  
Gray water tank (gals.).....20.00  
Black water/toilet tank  
(gals.).....4.75  
Propane (lbs.).....0  
Propane (gals.).....0  
Water heater (gals.).....0.00

### TIRES

Tire size (front):.....LT245/70R17 E  
Tire size (mid):.....  
Tire size (rear):.....LT245/70R17 E

\*\*\*Some dimensions may be rounded and may vary from the actual dimensions\*\*\*  
\*\*\*Weights may be estimated calculations and may vary from the actual weight  
- refer to the vehicle weight labels for actual weights\*\*\*  
Floorplans, features and specifications are subject to change without notice.