



ENTEGRA

Accolade



Serial #: 1J5NECBUXN11HM80058
Model: 37M ACCOLADE MH-C
VIN#: 4U2ADVFEC2NCN011382
Model Year: 2022 Dealer Name: National Indoor RV Center
1205 Bridgestone Parkway
La Vergne, TN 37056
USA

Manufacturer's Suggested Retail Price

\$296,880.00

TOTAL AMOUNT DOES NOT INCLUDE STATE AND LOCAL TAXES OR LICENSE FEES. THE PRICE SHOWN ABOVE MAY OR MAY NOT BE REPRESENTATIVE OF THE ACTUAL SELLING PRICE OF SIMILAR RECREATIONAL VEHICLES IN YOUR AREA.

ENTEGRA

COACH®

Serial #: 1JSNECBUXNH1M8058
Model: 37M ACCOLADE MHC
VIN#: 4UZADVFC2NCNM1382
Model Year: 2022 Dealer Name: National Indoor RV Centers
1205 Bridgestone Parkway
La Vergne, TN 37086
USA

Standard Equipment

THE FOLLOWING ITEMS ARE STANDARD ON THIS MODEL AT NO EXTRA CHARGE

EXTERIOR

- Flame-retardant SERV chassis
- Black powder paint finish
- GCWR - 43,000 lb.
- GVWR - 43,000 lb.
- Cummins ISB 6.7L 360 HP diesel engine with 800 hp torque
- Automatic 3,000 MH automatic transmission
- 15 amp alternator
- Gray vinyl exterior - 275/60R22.5
- 6 tie-downs
- 12,000-lb hitch with 1,200-lb tongue capacity and 7-foot pin
- 16-gal DEF tank
- 100-gal fuel tank
- 10-gal DEF tank
- Auto-gen start
- Transfer switch with reverse polarity protection
- 16' (9' A/CN) (22C/N) house batteries on island
- 35,000-BTU auto ignition furnace
- LP quick-connect hookup
- 24.5-gal propane tank (83 lb.)
- LP gas delivery system
- Exterior utility center
- Waterization drain system
- Outside shower
- TV demand water pump
- 12V demand water pump
- 12V demand water pump
- LED lighting - waterproof illuminated roof, floor and overhead
- Brake foam insulation (R-24 main roof, R-9 max)
- One-piece, seamless, crowned fiberglass roof
- Premium Skanks full-body paint
- Aluminum wheels
- Aluminum tires
- Aluminum rim
- Aluminum trim
- Carbon alarm
- Carbon monoxide detector

INTERIOR

- Power windows and door locks
- TV and stereo system
- Auxiliary circuit switch
- Primary cutting for cab area
- Overhead bunk with 750 lb. capacity
- Firmly Maxxap system
- LED ceiling lights
- Belt-in, interior ceiling height with standard vinyl ceiling
- Raised panel hardwood cabinetry throughout
- But bearing drawer guides
- Very quiet flooring
- LED HD Smart TV, 40" screen, large operation keyless remote table
- Cable TV hookup with HG-6 coax and video selector switch
- Wired 20 W/4G antenna
- 2 burner induction cooktop with spice cabinets
- LED-L solid surface kitchen countertops with recessed stainless steel sink
- Flip-up countertop extension (select models)
- Peculiar toilet with foot flush
- Recessed LED-L stainless steel bathroom sink
- Washroom vanity with integrated and independent handoperated and
- Under-bed storage (select models)
- Large wardrobes
- Backs with industry exclusive, 300-lb. capacity each (37L)
- Driver and passenger airbags
- Third brake light
- Proton light

CUSTOMER VALUE PACKAGE

- Interior LED-L lighting throughout
- Breaks, SACSIS stocks
- One-piece, stainless, fiberglass floor and rear caps
- Electric patio awning with LED lights
- Guardainless water heater
- Sony entertainment center with Apple CarPlay® and Android Auto™
- Backup and side-view cameras
- 21-cu ft. residential refrigerator with ice and water in door
- Residential size convection microwave

Optional Equipment

OPTIONAL EQUIPMENT INSTALLED ON THIS VEHICLE BY MANUFACTURER

	Base price
Crossville	289,300.00
Moonlight Full Paint	n/c
USA Standards	n/c
22 FT S2RV 31000 275"	n/c
360 NAYS	6,750.00
Customer Value Package	n/c
Residential Refrigerator	1,800.00
Natural Gas Dish Satellite	n/c
In-motion DISH Satellite System	750.00
Booth Dinette	30.00
Hide-A-Bed Sofa	

UNIT TOTAL

296,880.00

DEALER INSTALLED OPTIONS

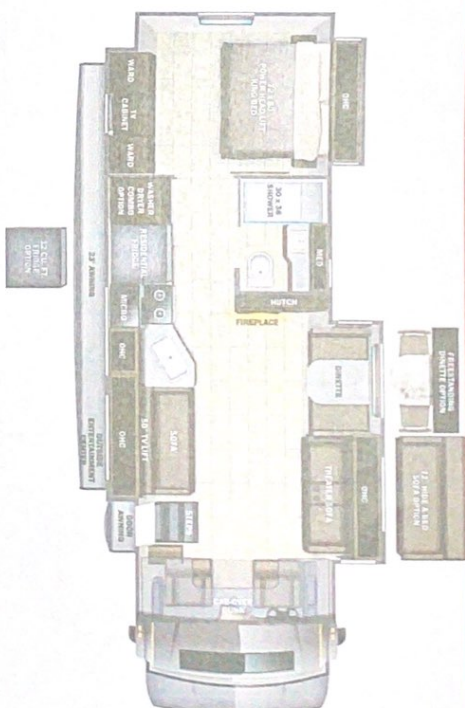

DIMENSIONS

Exterior height:.....	160.00"	Fresh water tank (gals.):..	72.00
Exterior width:.....	101.00"	Gray water tank (gals.):...	81.00

CAPACITIES

Fresh water tank (gals.)	72.00
Gray water tank (gals.)	81.00
Black water/toilet tank (gals.)	50.00
Propane (lbs.)	83
Propane (gals.)	19
Water heater (gals.)	0.00

TIRES

```
Tire size (front) :.....275/80R22.5G
Tire size (mid) :.....
Tire size (rear) :.....275/80R22.5G
```

Some dimensions may be rounded and may vary from the actual dimensions
 ***Weights may be estimated calculations and may vary from the actual weight
 - refer to the vehicle weight labels for actual weights***
 Floorslans, features and specifications are subject to change without notice.