



6156

Accolade XL



ENTEGRA

COACH®

Serial #: 1JSNECBU6N1LL8063
Model: 37L ACCOLADE XL MHC
VIN#: 4UZADVFCXCNCNS1932
Model Year: 2022 Dealer Name: NATIONAL INDOOR RV CENTERS

4640 NEXUS WAY
NORTH LAS VEGAS, NV 89115
USA

Standard Equipment

Optional Equipment

THE FOLLOWING ITEMS ARE STANDARD ON THIS MODEL.
AT NO EXTRA CHARGE

OPTIONAL EQUIPMENT INSTALLED ON THIS VEHICLE
BY MANUFACTURER

- EXTERIOR**
- Freightliner® S2RV front engine diesel "Super-C" cab chassis
 - Cummins® ISB 6.7L 360 HP diesel engine with 800 ft.-lb. torque
 - Allison® 3000 MH automatic transmission
 - Variable geometry engine exhaust brake
 - 185-amp alternator
 - Michelin® tires - 275/80R 22.5 14 ply
 - 12,000-lb. rear hitch receiver
 - 7-pin plug
 - Dual 12V chassis batteries - 1900 CCA
 - 100-gal. fuel tank
 - 13-gal. DEF tank
 - Onan® 8,000-watt diesel generator with auto-gen start
 - (4) 6V AGM (220Ah) house batteries on slideout tray
 - Solar prep
 - Dual 15,000-BTU A/C unit with heat pumps
 - Touchstone electric 5,000 BTU thermostat controlled fireplace
 - Thetford® San-Con Turbo Macerator system
 - Exterior utility center
 - Winterization drain system
 - Black tank flush
 - Outside shower
 - 12V demand water pump
 - Water filtration system
 - Power windows and door locks
 - Tilt and telescoping leather-wrapped steering wheel
 - TuffShell™ vacuum-bond laminated roof, floor and sidewalls
 - One-piece, seamless, crowned fiberglass roof
 - Bead-foam insulation (R-24 max roof, R-9 max floor, R-5 max walls)
 - One-piece, seamless, fiberglass front and rear caps
 - Automotive-bonded panoramic window in front cap with power shade
 - Premium Sikkens full-body paint
 - Automatic hydraulic leveling jacks
 - Alcoa® aluminum rims
 - Exterior entertainment center with outside speakers, LED TV mounted on swivel bracket and AM/FM radio
 - Wreguard® in-motion satellite dish
 - Deluxe heated, remote-controlled, side-view mirrors
 - Entrance door with industry's largest travel-view window
 - Electric-powered entrance step
 - Slideout cover awnings
 - Chrome exterior baggage door handles and locks
 - Carpeted, full pass-through storage compartments with lockable stern latch doors
 - Flush-mount LED marker lights

- INTERIOR**
- Power driver and passenger seats
 - Auxiliary start switch
 - Privacy curtains for cab area
 - Color-coordinated carpeted floor mat
 - Custom-molded ABS surround in cab-over area
 - Overhead bunk with 750 lb. capacity
 - Vega touch touchpad system for complete integration of coach controls (mobile app available)
 - High-intensity recessed LED ceiling lights
 - Raised-panel high-gloss hardwood cabinetry and stiles throughout
 - Deluxe hidden cabinet hinges
 - High-gloss, polished porcelain floor tile with heated floor mat
 - Multi-functional legless dinette table
 - 50 in. LED TV in living area (40 in. on 37K)
 - Sony Blu-Ray™ with HDMI® connections
 - Cable TV hookup with RG-6 coax and video selector switch
 - Wood-framed kitchen window with spice cabinets
 - 2-burner induction cooktop with LED display
 - Solid-surface kitchen countertop with large integrated stainless steel sink with sink covers
 - One-piece, fiberglass shower with glass door, skylight and light
 - Porcelain toilet with foot flush
 - Solid-surface bathroom sink
 - Powered roof vent in bathroom with wall switch
 - Walk-around, King-sized bed with bedspread and nightstands
 - 33" LED TV in bedroom
 - Large wardrobes

Base price	349,800.00
Onyx	n/c
Stonewall Gray Cabinetry	n/c
Exclude Linen Front	4,493.00
Overhead Accent Wood	
Blue Lighting Paint	n/c
USA Standards	30.00
22 FR S2RV 31000 27g*	n/c
360 NA15	n/c
Customer Value Package	11,250.00
No Washer/Dryer	n/c
8K Generator	n/c
IN Motion Satellite Dish	n/c
Hide-A-Bed Sofa	n/c

CUSTOMER VALUE PACKAGE

- E-Z DRIVE™ PREMIER: Computer-balanced driveshaft, rear air suspension, heavy-duty rear stabilizer bar, full air brakes, SACHS shocks
- Dual-pane, tinted, safety-glass windows
- Roof-mounted Girard® NOVA II dual-pitched patio awning with LED lights
- 2,000-watt pure sine wave inverter
- Power cord reel with 50-amp service
- Aqua-Hot® 250D hydronic water and heating system
- 9" Sony® infotainment center with Apple CarPlay® and Android Auto™
- Backup and side-view cameras
- 21-cu.ft. side-by-side residential refrigerator with ice and water in door
- Flush-mounted convection microwave

UNIT TOTAL

367,816.00

DEALER INSTALLED OPTIONS

10K Generator

2,243.00

Manufacturer's Suggested Retail Price

\$367,816.00

TOTAL AMOUNT DOES NOT INCLUDE STATE AND LOCAL TAXES OR LICENSE FEES. THE PRICE SHOWN ABOVE MAY OR MAY NOT BE REPRESENTATIVE OF THE ACTUAL SELLING PRICE OF SIMILAR RECREATIONAL VEHICLES IN YOUR AREA.

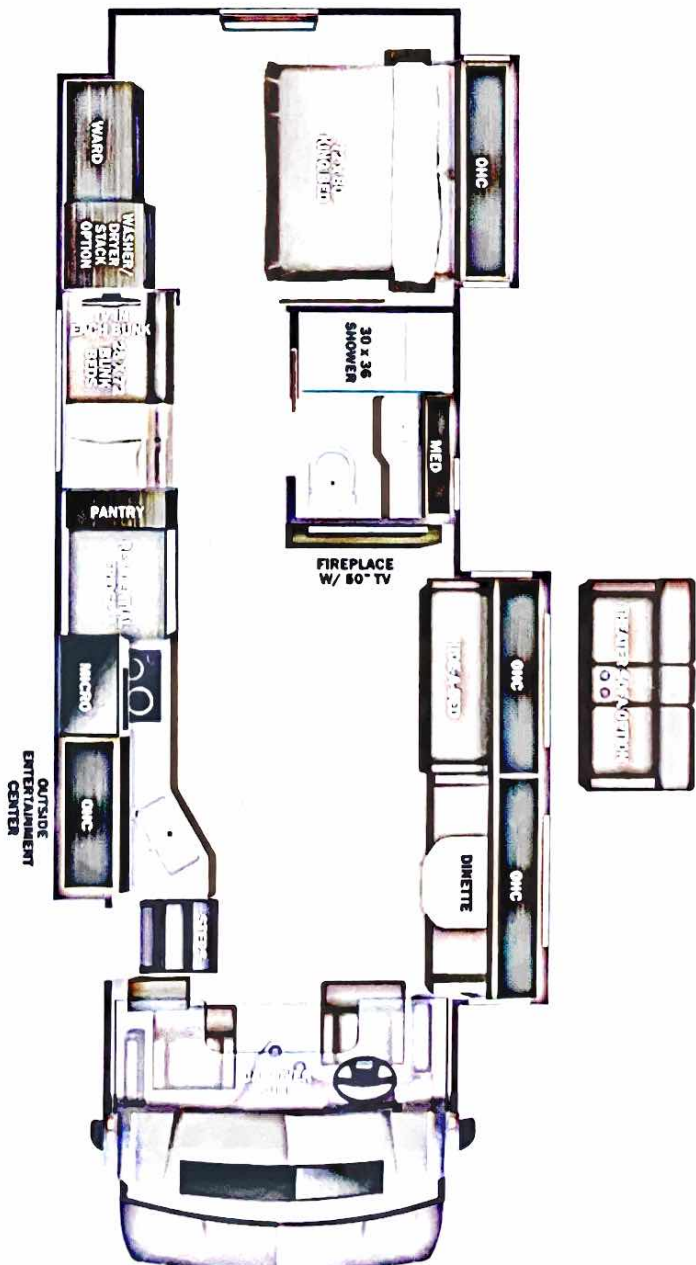

DIMENSIONS

Exterior height:.....160.00"
Exterior width:.....101.00"

CAPACITIES

Fresh water tank (gals.):...72.00
Gray water tank (gals.):...81.00
Black water/toilet tank (gals):.....50.00
Propane (lbs.):.....0
Propane (gals.):.....0
Water heater (gals.):.....0.00

TIRES

Tire size (front):.....275/80R22.5G
Tire size (mid):.....
Tire size (rear):.....275/80R22.5G

Some dimensions may be rounded and may vary from the actual dimensions
Weights may be estimated calculations and may vary from the actual weight
- refer to the vehicle weight labels for actual weights***
Floorplans, features and specifications are subject to change without notice.