



Redhawk

#6013



Serial #: 1UJLJCBN9M1XM4085
Model: 26M REDHAWK MHC
VIN#: 1FDXE4FN3MDC27008
Model Year: 2021 Dealer Name: NATIONAL INDOOR RV CENTERS
11280 N SOLAR CANYON WAY
SURPRISE, AZ 85379
USA

Standard Equipment

THE FOLLOWING ITEMS ARE STANDARD ON THIS MODEL
AT NO EXTRA CHARGE

- Exterior
 - Ford® E-450 chassis
 - 7.3L V-8 350 HP engine with 468 ft.-lb. torque
 - 6-speed TorqShift® series transmission with overdrive
 - 210-amp alternator
 - E-rated highway tires- LT225/75R16
 - Power anti-lock brakes with power steering
 - 7,500 lb. hitch with 750 lb. tongue capacity and 7-pin plug
 - 12V chassis battery
 - 55 gal. fuel tank
 - Remote-controlled, sideview mirrors
 - StrongholdVBL™ Vacuum-Bond laminated roof, floor and sidewalls
 - Bead-foam insulation (R-15 max roof, R-9 max floor, R-5 max walls)
 - TPO laminated roof
 - Fiberglass exterior walls with vinyl graphics
 - Frameless windows
 - Remote keyless entry
 - Aluminum running boards
 - Entrance door with industry's largest travel view window
 - 12V house battery
 - Slideout cover awnings
 - Electric-powered entrance step with integrated house battery compartment
 - Pass-through storage compartment with light (select models)
 - Onan® 4,000-watt MicroQuiet™ generator with auto-changeover
 - 12.2 gal. propane tank (41 lb.)
 - LP quick-connect hookup
 - (2) high-output, marine-grade exterior speakers
 - 30-amp electrical service
 - Exterior utility center
 - Winterization drain system
 - Outside shower
 - 4 in. bumper-tube sewer hose storage
 - Roof ladder
 - Leveling jack prep
 - 6 gal. gas/electric DSI auto-ignition water heater
 - Solar prep
 - Third brake light
 - Porch light

- Interior
 - Swivel driver and passenger seats (N/A 22J, 25R)
 - Tire pressure monitoring system (TPMS)
 - Driver and passenger air bags
 - Power windows and door locks
 - Tilt steering wheel
 - A/C and cruise control
 - Auxiliary start switch
 - Privacy curtains for cab area
 - 84 in. ceiling height
 - High-intensity, recessed LED ceiling lights
 - LED-lit fascia
 - Hardwood cabinet doors and drawers
 - Ball-bearing drawer guides
 - Furrion® all-in-one cooktop and oven
 - Convection microwave
 - LED-lit pressed countertops
 - Stainless steel kitchen sink
 - Decorative kitchen backsplash
 - Pop-up charging station with 110 outlet and USB plugs
 - Interior entrance door grab handle
 - 12V demand water pump
 - Water filtration system
 - Jayco-exclusive easy operation legless dinette table
 - 2-point lap safety belts in all designated seating locations
 - Interior command center
 - Pleated blackout shades
 - Cable TV hookup with RG-6 coax
 - Digital antenna with signal booster
 - 15,000 BTU ducted A/C
 - 31,000 BTU auto-ignition furnace
 - Prep for satellite dish
 - Shower with decorative ABS surround and skylight
 - Toilet with foot flush
 - Stainless steel bathroom sink
 - Vent fan in bathroom
 - Queen-sized bed with bedspread
 - Under-bed storage (select models)
 - Large wardrobes
 - Overhead bunk with 750 lb. capacity
 - Bunks with industry-exclusive 300 lb. capacity each (31F)
 - Smoke alarm
 - Carbon monoxide detector

- Customer Value Package
 - JRIIDE®: Computer-balanced driveshaft, standard front and rear stabilizer bars, Hellwig® helper springs, rubber isolation body mounts
 - Sony® infotainment center Apple CarPlay® and Android Auto™
 - One-piece, seamless, fiberglass front cap
 - Electric patio awning with LED lights
 - Black holding tank sprayer
 - Rear backup camera
 - Heated holding tanks (12V pads)
 - 8 cu. ft. flush-mount, double-door refrigerator
 - LED HDTV in living area

Optional Equipment

OPTIONAL EQUIPMENT INSTALLED ON THIS VEHICLE
BY MANUFACTURER

Base price	108,518.00
Modern Farmhouse	443.00
USA Standards	n/c
21 FD E45 14500 158"	n/c
7.3L WHITE MXX	6,000.00
Customer Value Package	
Hydraulic Auto Leveling	3,893.00
Jacks	n/c
Standard House Battery	n/c
Dinette	n/c

UNIT TOTAL 118,854.00

DEALER INSTALLED OPTIONS

Manufacturer's Suggested Retail Price \$118,854.00

TOTAL AMOUNT DOES NOT INCLUDE STATE AND LOCAL TAXES OR LICENSE FEES. THE PRICE SHOWN ABOVE MAY OR MAY NOT BE REPRESENTATIVE OF THE ACTUAL SELLING PRICE OF SIMILAR RECREATIONAL VEHICLES IN YOUR AREA.

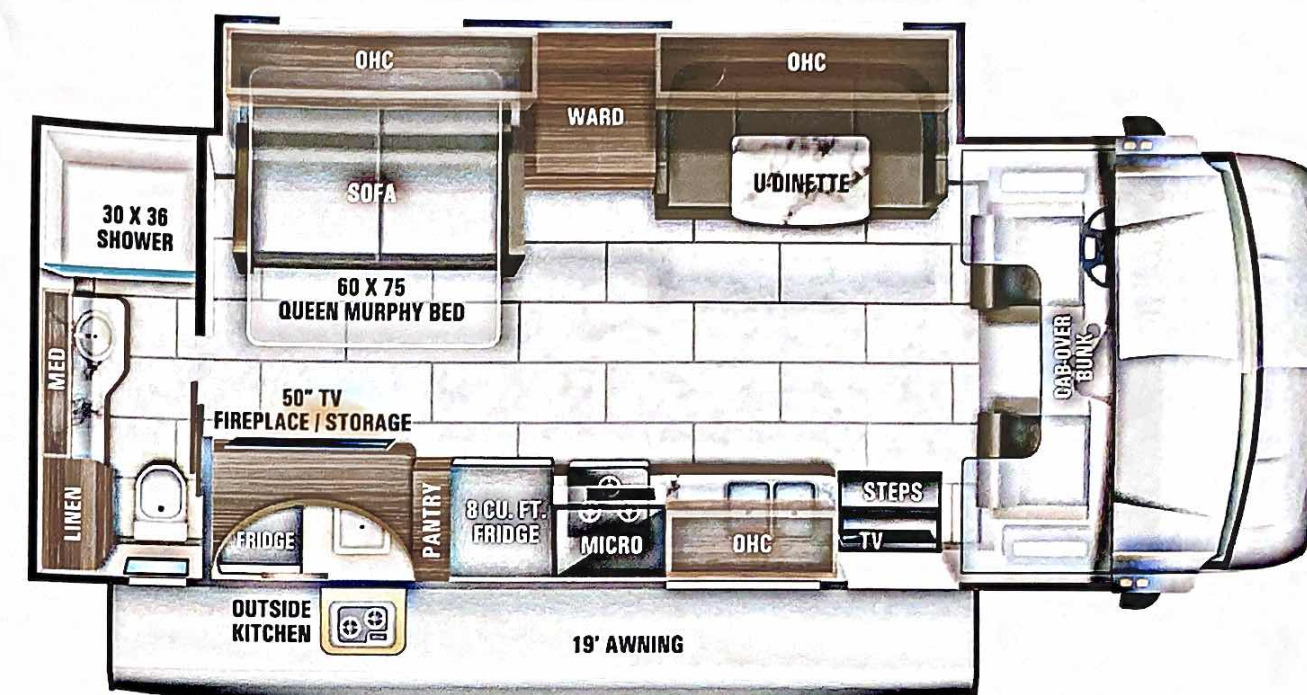

DIMENSIONS

Exterior height:.....138.00"

Exterior width:.....100.00"

CAPACITIES

Fresh water tank (gals.):...43.50

Gray water tank (gals.):...40.00

Black water/toilet tank (gals.):...31.00

Propane (lbs.):...41

Propane (gals.):...9

Water heater (gals.):...6.00

TIRES

Tire size (front):.....LT225/75R16E

Tire size (mid):.....

Tire size (rear):.....LT225/75R16E

Some dimensions may be rounded and may vary from the actual dimensions

***Weights may be estimated calculations and may vary from the actual weight

- refer to the vehicle weight labels for actual weights***

Floorplans, features and specifications are subject to change without notice.

2+3
YEAR | YEAR
LIMITED | STRUCTURAL
WARRANTY