



ENTEGRACOACH®

Odyssey

Serial #: 1JSLCGBM1M1EB8245  
Model: 24B ODYSSEY MHC  
VIN#: 1FDXE4FNM0MDC29363  
Model Year: 2021 Dealer Name: NATIONAL INDOOR RV CENTERS  
4640 NEXUS WAY  
NORTH LAS VEGAS, NV 89115



Standard Equipment

Optional Equipment

THE FOLLOWING ITEMS ARE STANDARD ON THIS MODEL AT NO EXTRA CHARGE

OPTIONAL EQUIPMENT INSTALLED ON THIS VEHICLE BY MANUFACTURER

- Exterior
  - Ford® E-450 chassis
  - 7.3L V8 350 HP engine with 468 lb. torque
  - 6-speed TorqShift® 6R80 transmission with over-drive
  - 210-amp alternator
  - Rated highway tires: LT225/75R16
  - Power air-ride brakes with power steering
  - Power mirrors with 750 lb. tongue capacity and 7-pin plug
  - 12V chassis battery
  - 35 gal. fuel tank
  - 11" vacuum-bond laminated roof, floor and sidewalls
  - Best foam insulation (R-24 max roof, R-9 max floor, R-5 max walls)
  - Fiberglass exterior walls with vinyl graphics
  - Flameless windows
  - Slideout cover awnings
  - 15,000 BTU ducted A/C
  - 30,000 BTU auto-ignition furnace
  - LP gas powered hoodup
  - LP gas powered hoodup
  - Water filtration system
  - 6 gal. gas/electric DSI auto-ignition water heater
  - Pressurized water pump
  - 100 gal. storage compartment with light (select models)
  - 4 in. bumper-lube sewer hose storage
  - Remote keyless entry
  - Electric door with industry's largest travel view window
  - Electric-powered entrance step with integrated house battery compartment
  - Electric-powered entrance step with integrated exterior speakers
  - Remote-controlled, sideview mirrors
  - Outside shower
  - Aluminum leveling boards
  - Third brake light
  - Power windows and door locks
  - Onan® 1000-watt MicroQuattro® generator
  - Solar prep battery
  - Exterior utility center
  - Ventilation drain system
  - Flood light
- Interior
  - Custom-molded ABS surround in cab-over area
  - Swivel driver and passenger seats with boosters (N/A 25R)
  - Triple-circuit hydraulic brake area
  - Tire pressure monitoring system (TPMS)
  - Leveling jack prep
  - Auxiliary start switch
  - Full steering wheel, AC and cruise control
  - LED light package
  - Interior command center
  - High-intensity, recessed LED ceiling lights
  - Interior entrance door grab handle
  - Prep for satellite dish
  - Digital antenna with signal booster
  - Pop-up charging station with 110 outlets and USB ports
  - Furnace® all-in-one cooktop and oven
  - LED lit, pressed countertops
  - Engine-exclusive battery compartment
  - Ball-bearing drawer guides
  - Convection microwave
  - Recessed stainless steel kitchen sink with cutting board sink
  - Queen-sized bed with bedspread (King-sized in 27U)
  - Large wastebins
  - Under-bed storage (select models)
  - Shower with decorative surround, glass door, skylight and light
  - Porcelain toilet with foot flush
  - Electric heated floor in bedroom sink
  - Bunks with industry-exclusive 300 lb. capacity each (31F)
  - 2-point lap safety belts in all designated seating locations
  - Bunking up passenger air bags
  - Smoke alarm
  - Carbon monoxide detector
- Customer Value Package
  - EZDRIVE™: Computer-balanced driveshaft, standard front and rear stabilizer bars, Hellwig® helper springs, rubber 8 cu. ft. flush-mount, double-door refrigerator
  - LED HDTV in living area
  - Backup and sideview cameras
  - One-piece, seamless, fiberglass front cap
  - Automotive-bonded, panoramic window in front cap with power shade
  - Apple® infotainment center Apple CarPlay® and Android Auto®
  - Heated holding tanks (12V pads)
  - Black holding tank sprayer

UNIT TOTAL 116,364.00

DEALER INSTALLED OPTIONS

Manufacturer's Suggested Retail Price \$116,364.00

TOTAL AMOUNT DOES NOT INCLUDE STATE AND LOCAL TAXES OR LICENSE FEES. THE PRICE SHOWN ABOVE MAY OR MAY NOT BE REPRESENTATIVE OF THE ACTUAL SELLING PRICE OF SIMILAR RECREATIONAL VEHICLES IN YOUR AREA.

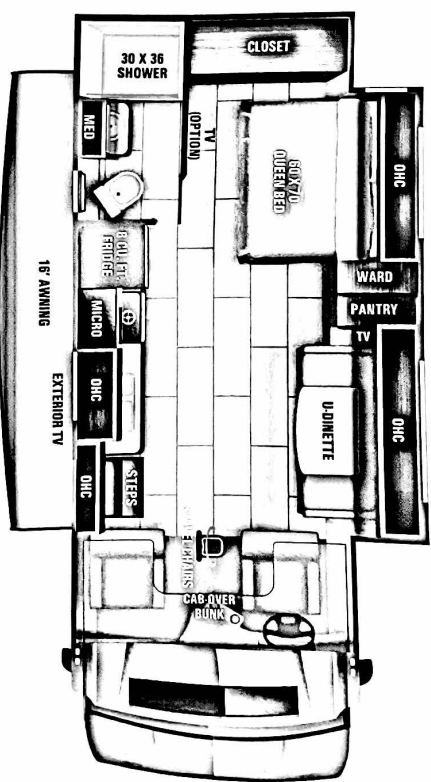

DIMENSIONS

Exterior height: 140.00"  
Exterior width: 100.00"

CAPACITIES

Fresh water tank (gals.): 43.50  
Gray water tank (gals.): 40.00  
Black water/coilet tank (gals.): 31.00  
Propane (lbs.): 41  
Water heater (gals.): 9

TIRES

Tire size (front): LT225/75R16  
Tire size (mid): LT225/75R16  
Tire size (rear): LT225/75R16

\*\*\*Some dimensions may be rounded and may vary from the actual dimensions\*\*\*  
\*\*\*Weights may be estimated calculations and may vary from the actual weight\*\*\*  
- refer to the vehicle weight labels for actual weights\*\*\*  
Floorplans, features and specifications are subject to change without notice.