



ENTEGRA
COACH®

Anthem



Serial #: 1JSMEACV5M14F8082
Model: 44F ANTHEM MHA
VIN#: 4VZAU1D91MC089880
Model Year: 2021 Dealer Name: NATIONAL INDOOR RV CENTERS
11280 N SOLAR CANYON WAY
SURPRISE, AZ 85379
USA

Manufacturer’s Suggested Retail Price \$581,438.00

TOTAL AMOUNT DOES NOT INCLUDE STATE AND LOCAL TAXES OR LICENSE FEES. THE PRICE SHOWN ABOVE MAY OR MAY NOT BE REPRESENTATIVE OF THE ACTUAL SELLING PRICE OF SIMILAR RECREATIONAL VEHICLES IN YOUR AREA.

Standard Equipment

THE FOLLOWING ITEMS ARE STANDARD ON THIS MODEL
AT NO EXTRA CHARGE

Exterior
- Spartan® K2 raised-rail chassis
- Cummins® L9 turbocharged 450 HP engine 1,250 lb. ft. torque at 1,400 RPM
- Allison® 3,000 MH 6-speed transmission
- Side-mounted radiator
- Equalizer hydraulic automatic coach leveling
- Valid air leveling system with auxiliary air compressor
- Sidewalls- 2-1/2" exterior walls with Aluma-Tru™ welded tubular aluminum studs on 16" centers or less filled with bat and Flexfoil insulation then covered with high-gloss gelcoat fiberglass (R-16)
- Floors- 2" x 4" wood trusses on 16" centers or less filled with bat and Flexfoil insulation then topped with 3/4" 7-ply plywood decking (R-33)
- X-Bridge™ bracing welded into chassis frame
- Steel-reinforced front cap and windshield frame
- Insulated front and rear caps (R-24)
- Roof- 4" arched aluminum trusses filled with bat insulation and reflective Flexfoil® topped with 3/8" plywood decking then one-piece fiberglass
- Entegra-exclusive Relia-Torque flush-mounted 12V slideout system with VegaTouch and push button controls
- Aqua-Hot® heated basement storage on thermostat
- (3) 15,000 BTU A/C units with heat pumps and condensation drain system
- (4) L16 AGM batteries (6V/390 amp hrs. ea.)
- Sani-Con® Macerator holding tank dump system with manual gate valves and manual backup
- 50 amp power cord on electric powered reel
- Onan® 12,500 watt diesel generator, with automatic start, on powered slide-out tray
- Aqua-Hot® 450D hydronic water and heating system with in-floor heat throughout and engine preheat
- (2) 3,000 watt pure sine wave inverters
- Premium surge protector transfer switch
- Water hose with electric reel
- City and tank water filtration system
- Trutank™ ultrasonic tank monitoring system displayed on VegaTouch screen
- LED accent lights under passenger slideout rooms
- (1) power slideout basement storage tray
- 2.8 cu.ft. exterior Dometic® refrigerator/freezer on slideout tray
- Daytime running lights
- Girard® power entrance door awning with LED lights
- Dual roof-mounted Girard® Vision dual pitched patio awnings with LED lights
- Girard® Ultra slideout awnings
- Girard® Ultra window awnings
- Power engine door with manual override
- Diamond Shield™ front protective film mask
- 43" Samsung® 4K UHD Slim, Smart TV wand
Bose® Solo 5 sound bar on TV bracket with extend, tilt and swivel arm
- LED high/low beam headlights and fog lights
- Lit grab handle with keypad system for keyless entry
- Chrome, heated, remote control, side-view mirrors with integrated cameras and blind-spot indicators
- Winegard® TRAV'LER satellite dish DIRECTV®-standard with USA option
- Winegard® WIFI extender with 4G/LTE
- Premier Bus Armor 8" stainless steel trim
- Heated exterior utility center with 5" LED Firefly® tank monitoring panel
- Winegard® Rayzar automatic powered TV antenna
- Frameless, tinted, dual-pane, safety-glass windows

Interior
- (2) dual USB ports and (2) 12V socket for charging
- Xite™ 360° camera system that displays on digital dash screen
- Valid 15" digital dash with selector knob and three main selection screens
- Villa® 6-way power, lumbar, heated Ultraleather® driver and passenger seats with integrated seatbelt
- Powered flush stepwell cover
- Dual, glass panel 9" touchscreen in-dash infotainment center with Rand McNally™ RV navigation, Bluetooth, SiriusXM™, AM/FM tuner, integrated camera control, house mode whole coach audio distribution, and integrated VegaTouch coach control
- Blind spot monitoring system displayed on digital dash screen
- Powered adjustable brake and accelerator pedals
- Tire pressure monitoring system (TPMS) with temperature monitoring
- Push button start system
- E-Z Steer™ electric, adjustable power steering assist with steering angle sensor
- VIP wood-grain, leather-wrapped, power tilt and telescoping steering wheel with integrated controls for radio, cruise, wipers, and Bluetooth phone functionality
- JBL® premium audio 11-speaker sound system with amplifier, speakers and DVC subwoofer
- Powered front sun visors and privacy shade
- Ultra-Vision® one-piece wrap-around tinted windshield
- Central vacuum system
- Sony® HD Blu-Ray™ player
- LED lit fireplace with 1500w heating element (44B, 42DEQ, 44Z)
- Hand-laid, high-gloss porcelain floor tiles
- Premium Villa Ultraleather® furniture
- Aire-Secure™ travel locks for all pocket doors
- 10" VegaTouch touchpad system for complete integration of coach controls (mobile app available)
- Premium LED 12V recessed ceiling lighting
- Powered solar day and black out night shades
- 50" Samsung® 4K UHD Smart TV
- 32" Samsung® LED Slim 1080P Smart TV in front overhead
- Bose® SoundTouch 300 sound system
- Whirlpool® stacked washer and dryer
- Induction cooktop with matching wood cover
- 24" stainless EZ clean Fisher and Paykel dishwasher
- Solid surface countertops with Blanco single bowl granite sink and dimmable LED accent lighting
- Porcelain tile backsplash
- Whirlpool® 1.9 cu. ft. convection microwave oven
- Whirlpool® stainless steel residential refrigerator with ice maker and water dispenser
- Maxxair® power vent exhaust fan with intake
- Large deep drawer for waste basket with easy access trash chute (trash chute not available in 44F)
- Select Comfort® Sleep Number® king-sized mattress
- Large cedar-lined wardrobe with motion activated LED light
- Ceiling fan in bedroom
- Sony® Blu-Ray™ player
- Nightstands with USB ports and solid surface tops
- Bose® Solo 5 sound bar in bedroom
- 32" Samsung® LED, HD Slim 1080P Smart TV in bedroom
- Solid surface countertops with integrated glass sink and dimmable LED accent lighting in master bath
- Porcelain tiled shower wall with skylight and clear glass shower door
- Fixed shower head with separate hand held spray wand
- Teakwood shower seat (Not available in 44F)
- SaniFlo macerator toilet in main bath(N/A 42DEQ and 44Z)
- Carbon monoxide detector and smoke alarm
- Porch light and motion sensor security lights
- Safe

Optional Equipment

OPTIONAL EQUIPMENT INSTALLED ON THIS VEHICLE
BY MANUFACTURER

Base price 579,855.00
Champagne n/c
Paint Ballet n/c
USA Standards n/c
21 SP 52000 320" 450 TAG
AXLE 2017 EMISSIONS MXZ n/c
Natural Cherry Hardwood
Cabinetry n/c
White Accent Bathroom
Wood n/c
No Dishwasher Drawer n/c
Winegard Trav'ler
Satellite Antena W/DISH
Network n/c
Fireplace with TV
Entertainment 375.00
No Theater Seating Sofa n/c
SIS ins Tecma toilet ILO
Saniflow macerator 750.00
SIS ins desk w/pullout
drawer&printer drawer
ilo cooler 458.00

UNIT TOTAL 581,438.00

DEALER INSTALLED OPTIONS

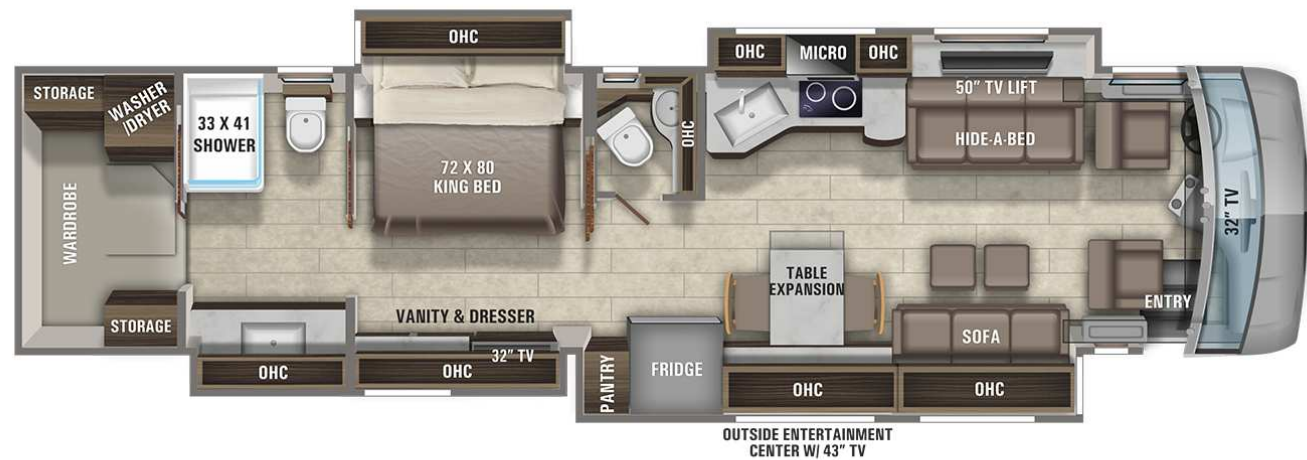

DIMENSIONS

Exterior height:.....152.00"
Exterior width:.....101.00"

CAPACITIES

Fresh water tank (gals.):...100.00
Gray water tank (gals.):....62.00
Black water/toilet tank (gals.):.....41.00
Propane (lbs.):.....0
Propane (gals.):.....0
Water heater (gals.):.....0.00

TIRES

Tire size (front):.....365/70R22.5
Tire size (mid):.....315/80R22.5
Tire size (rear):.....315/80R22.5

Some dimensions may be rounded and may vary from the acutal dimensions

***Weights may be estimated calculations and may vary from the actual weight

- refer to the vehicle weight labels for actual weights***

Floorplans, features and specifications are subject to change without notice.