



ENTEGRA COACH®

Esteem



Serial #: 1JSLECBN8N1BU8123
 Model: 27U ESTEEM MHC
 VIN#: 1FDXE4FN3NDCC41007
 Model Year: 2022 Dealer Name: NATIONAL INDOOR RV CENTERS

4640 NEXUS WAY
 NORTH LAS VEGAS, NV 89115
 USA

Standard Equipment

THE FOLLOWING ITEMS ARE STANDARD ON THIS MODEL AT NO EXTRA CHARGE

- EXTERIOR**
- Forc® E-450 chassis
 - GVWR - 14,500 lb.
 - GCWR - 22,000 lb.
 - 7.3L V-8 350 HP engine with 468 ft.-lb. torque
 - 6-speed TorqShift® series transmission with overdrive
 - 210-amp alternator
 - E-rated highway tires- LT225/75R16
 - Power anti-lock brakes with power steering
 - 7,500-lb. hitch with 750-lb. tongue capacity and 7-pin plug
 - 12V chassis battery
 - 55-gal. fuel tank
 - Onan® 4,000-watt MicroQuiet™ generator with auto-changeover
 - Transfer switch with reverse polarity protection
 - 30-amp electrical service
 - 12V house battery
 - 190W solar panel with dual controller and second house battery
 - Heated holding tanks (12V pads)
 - 15,000-BTU A/C with heat pump
 - 30,000-BTU auto-ignition furnace
 - 6-gal. gas/electric DSI auto-ignition water heater
 - 16.5-gal. propane tank (56 lb.)
 - LP quick-connect hookup
 - Exterior utility center
 - Winterization drain system
 - Outside shower
 - 12V demand water pump
 - Water filtration system
 - TuffShell™ vacuum-bond laminated roof, floor and sidewalls
 - Bead-foam insulation (R-24 max roof, R-9 max floor, R-5 max walls)
 - One-piece, seamless, fiberglass roof
 - Fiberglass running boards
 - Fiberglass side wings
 - Fiberglass exterior walls with vinyl graphics
 - Entrance door with industry's largest travel-view window
 - Electric-powered entrance step with integrated house battery compartment
 - Slideout cover awnings
 - Lockable storage compartments with slam latches
 - 4-in. bumper tube sewer hose storage
 - Roof ladder
 - Third brake light

Optional Equipment

OPTIONAL EQUIPMENT INSTALLED ON THIS VEHICLE BY MANUFACTURER

- INTERIOR**
- Remote keyless cab entry
 - Swivel driver and passenger seats with boosters (N/A 30X)
 - Tire pressure monitoring system (TPMS)
 - Power windows and door locks
 - A/C and cruise control
 - Tilt steering wheel
 - Auxiliary start switch
 - Privacy curtains for cab area
 - Custom-molded ABS surround in cab-over area
 - Overhead bunk with 750 lb. capacity and safety net
 - 84-in. interior ceiling height with padded vinyl ceiling
 - High-intensity recessed LED ceiling lights
 - LED-lit fascia with decorative insert
 - Hardwood cabinet doors and drawers
 - Ball-bearing drawer guides
 - Blackout night roller shades
 - Interior command center
 - Entegra-exclusive, easy-operation legless dinette table
 - LED HD Smart Fire TV in living area
 - Prep for satellite dish
 - Cable TV hookup with RG-6 coax
 - Wireguard 2.0 Wifi/4G antenna
 - 8-cu. ft. gas/electric refrigerator
 - Furrion® all-in-one cooktop and oven
 - Residential-size microwave
 - Recessed stainless steel kitchen sink with solid-surface covers
 - Flip-up countertop extension (select models)
 - Decorative kitchen backsplash
 - Pop-up charging station in kitchen with 110 outlets and USB ports
 - Shower with decorative surround, glass door, skylight and light
 - Recessed stainless steel bathroom sink
 - Porcelain toilet with foot flush
 - Powered roof vent in bathroom with wall switch
 - Walk-around, Queen-size bed with bedspread and nightstands (King size in 27U)
 - Under-bed storage (select models)
 - Powered roof vent in bedroom with wall switch
 - Large wardrobes
 - Bunks with industry-exclusive 300-lb. capacity each (31F)
 - 2-point lap safety belts in all designated seating locations
 - Driver and passenger airbags
 - Smoke alarm
 - Carbon monoxide detector

Base price	153,293.00
Brighton Sandpiper Full Body Paint	n/c
USA Standards	8,243.00
22 FD E45 14500 158"	n/c
7.3L WHITE NC10	n/c
Customer Value Package	9,000.00
Dual A/Cs	1,193.00
12 Cu. Ft. Refrigerator	2,843.00
Aluminum Rims	2,393.00
Standard House Battery	n/c
Sun Folding Windshield Shade	443.00

- CUSTOMER VALUE PACKAGE**
- EZ DRIVE™ ELITE: Computer-balanced driveshaft, Kom® FSD shocks, heavy-duty rear stabilizer bar, standard front stabilizer bar, Helwig® helper springs, rubber isolation mounts
 - One-piece, seamless, fiberglass front cap
 - Automotive-bonded panoramic window in front cap with power shade
 - Automatic hydraulic leveling jacks
 - Frameless windows
 - Electric patio awning with LED lights
 - Exterior LED TV with (2) high-output, marine-grade exterior speakers
 - 1,000-watt inverter
 - Chrome, heated, remote-controlled, side-view mirrors
 - Sony® infotainment center with Apple CarPlay® and Android Auto™
 - Backup and side-view cameras
 - LED-lit, solid-surface kitchen countertops
 - LED TV in bedroom

UNIT TOTAL

177,408.00

DEALER INSTALLED OPTIONS

Manufacturer's Suggested Retail Price \$177,408.00

TOTAL AMOUNT DOES NOT INCLUDE STATE AND LOCAL TAXES OR LICENSE FEES. THE PRICE SHOWN ABOVE MAY OR MAY NOT BE REPRESENTATIVE OF THE ACTUAL SELLING PRICE OF SIMILAR RECREATIONAL VEHICLES IN YOUR AREA.

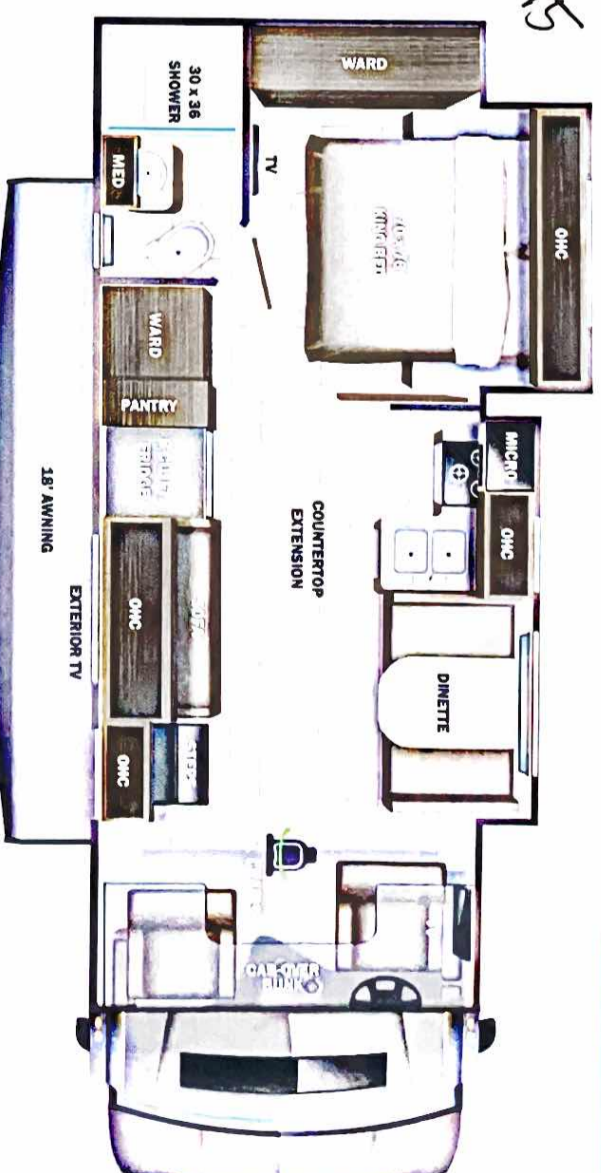

DIMENSIONS

Exterior height:.....140.00"
 Exterior width:.....100.00"

CAPACITIES

Fresh water tank (gals.):...42.50
 Gray water tank (gals.):...41.00
 Black water/toilet tank (gals.):...31.00
 Propane (lbs.):...56
 Propane (gals.):...13
 Water heater (gals.):...0.00

TIRES

Tire size (front):.....LT225/75R16E
 Tire size (mid):.....
 Tire size (rear):.....LT225/75R16E

Some dimensions may be rounded and may vary from the actual dimensions
 ***Weights may be estimated calculations and may vary from the actual weight
 - refer to the vehicle weight labels for actual weights***
 Floorplans, features and specifications are subject to change without notice.