



ENTEGR A COACH®

Vision XL



Serial #: 1J5MEABU6M1UA8090
 Model: 36A VISION XL MHA
 VIN#: 1F66F5DN3L0A17779
 Model Year: 2021 Dealer Name: NATIONAL INDOOR RV CENTERS
 4640 NEXUS WAY
 NORTH LAS VEGAS, NV 89115
 USA

Standard Equipment

THE FOLLOWING ITEMS ARE STANDARD ON THIS MODEL AT NO EXTRA CHARGE

- Exterior
 - Furrer F53 chassis
 - 7.3L V4 350 HP engine with 468 ft. lb. torque
 - 6-speed electronic TorqShift™ transmission with 210-torque converter
 - 210-amp alternator
 - G-rated highway tires- 235/60R22.5 (34B, 34G), 235/60R22.5 (36A), 4-wheel anti-lock brakes
 - 5,000 lb. rear hitch receiver with dual connector with 7-pin plug
 - 12V chassis battery
 - 120 in. panoramic windshield
 - TuffShel™ vacuum-bond laminated roof, floor and sidewalls
 - 10 ft. max width
 - LP quick-connect hookup
 - Solar pump
 - LP quick-connect hookup
 - Exterior utility cabinet system
 - Black tank flush
 - Outside shower
 - Porch light
 - Foot ladder
- Interior
 - Power front privacy shade with manual side privacy shades
 - 6-way power driver seat
 - Swivel driver and passenger seats
 - 12V power windows
 - Removable aluminum dash
 - A/C and cruise control
 - Tilt steering wheel
 - Auxiliary start
 - LED tilt ceiling height with padded vinyl ceiling
 - LED tilt hardwood lacase
 - Ball-bearing drawer guides
 - Hardwood cabinet doors and drawers
 - LED interior lighting
 - 12V DC power outlets
 - (2)30,000 BTU (36A)
 - Furnace SS-5000 BTU (34B, 34G), (330,000 BTU (36A)
 - 21 cu. ft. residential refrigerator with ice and water in door
 - Residential refrigerator with ice and water in door
 - Residential-sized microwave
 - Powered roof vent in kitchen with wall switch
 - Decorative kitchen backsplash
 - Dishwasher
 - Demand water pump
 - 12V water heater
 - Water filtration system
 - Electric-powered easy operation legless dinette table
 - Z-pivot lap safety seats in designated seating locations
 - 12V power outlets
 - LED lighting
 - Bluetooth™ player in living area
 - Cable TV hookup with RG-6 coax and video selector switch
 - Prep for satellite dish
 - Porcelain toilet with foot flush
 - Porcelain toilet with foot flush
 - Shower with decorative surround, glass door, skylight and light
 - Walk-around roof vent in bathroom with wall switch
 - Walk-around king-sized bed with bedspread and nightstands
 - Under-bed storage (selected models)
 - 12V power outlets
 - LED TV
 - 12V power outlets
 - Bunks with industry-exclusive 300 lb. capacity each (36A)
 - Smoke alarm
 - Carbon monoxide detector
 - Customer Value Package
 - EZDRIVE™ - Computer-balanced driveshaft, Jounce bumpers, heavy-duty front and rear stabilizer bars, SHOCKS
 - SmartPlay™ infotainment center with Apple CarPlay® and Android Auto™
 - Automatic hydraulic leveling jacks
 - Backup and sideview cameras
 - OnStar®
 - OnStar® Marcus Gold General 5,500-watt generator with auto-gen start
 - 1,200-watt inverter
 - 5-amp electrical outlets
 - 12V power outlets
 - Sideout cover awnings with LED lights
 - Exterior entertainment center with outside speakers, LED TV mounted on swivel bracket and single-disc DVD/MP3 radio
 - LED interior surface kitchen countertops with recessed stainless steel sink and sink covers
 - Removable driver/passenger cockpit table
 - Day/night roller shades
 - 15,500 BTU A/C unit with heat pump and second 13,500 BTU A/C unit

Optional Equipment

OPTIONAL EQUIPMENT INSTALLED ON THIS VEHICLE BY MANUFACTURER

Base price	160,193.00
Modern Farmhouse	443.00
Decorative Paint Package	12,750.00
USA Start Value Package	N/C
Residential Refrigerator	11,250.00
Front Bunk Overhead Theater Seating Sofa w/Power	N/C
	2,993.00
	2,018.00

UNIT TOTAL **189,647.00**

DEALER INSTALLED OPTIONS:

Manufacturer's Suggested Retail Price **\$189,647.00**

TOTAL AMOUNT DOES NOT INCLUDE STATE AND LOCAL TAXES OR LICENSE FEES. THE PRICE SHOWN ABOVE MAY OR MAY NOT BE REPRESENTATIVE OF THE ACTUAL SELLING PRICE OF SIMILAR RECREATIONAL VEHICLES IN YOUR AREA.

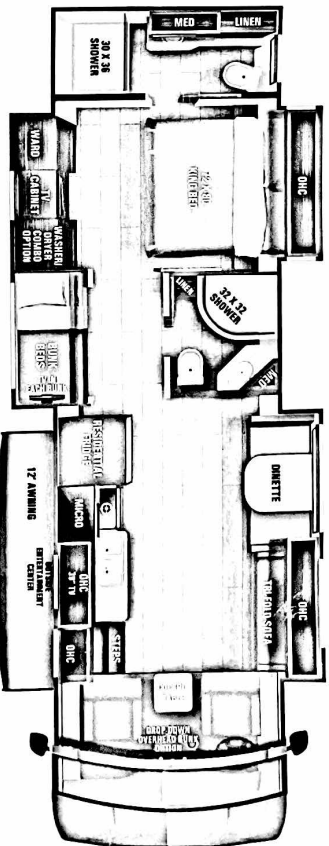

DIMENSIONS
 Exterior height:154.00*
 Exterior width:101.00*

CAPACITIES
 Fresh water tank (gals.):72.00
 Gray water tank (gals.):80.00
 Black water/toilet tank (gals.):102.00
 Propane (lbs.):56
 Propane (gals.):13
 Water heater (gals.):10.00

TIRES
 Tire size (front):255/80R22.5G
 Tire size (mid):255/80R22.5G
 Tire size (rear):255/80R22.5G

Some dimensions may be rounded and may vary from the actual dimensions
 Weights may be estimated calculations and may vary from the actual weight
 - refer to the vehicle weight labels for actual weights***
 Floorplans, features and specifications are subject to change without notice.