



Precept

# 4994



Serial #: 1UJMJABR3M1UL4137  
Model: 31UL PRECEPT MHA  
VIN#: 1F66F5DN2L0A15795  
Model Year: 2021 Dealer Name: NATIONAL INDOOR RV CENTERS  
11280 N SOLAR CANYON WAY  
SURPRISE, AZ 85379  
USA

## Standard Equipment

THE FOLLOWING ITEMS ARE STANDARD ON THIS MODEL  
AT NO EXTRA CHARGE

- Exterior
  - Ford® F53 chassis
  - 7.3L V-8 350 HP engine with 468 ft.-lb. torque
  - 6-speed automatic TorqShift® transmission with overdrive and tow haul mode
  - 210-amp alternator
  - G-rated highway tires - 245/70R19.5 (29V), 235/80R22.5 (31UL, 34B, 34G), 255/80R22.5 (36A)
  - Front and rear disc, 4-wheel anti-lock brakes
  - 5,000 lb. rear hitch receiver with dual connector and 7-pin plug
  - 12V chassis battery
  - 80 gal. fuel tank
  - 120 in. panoramic windshield
  - Stronghold/VBL™ Vacuum-Bond laminated roof, floor and sidewalls
  - Bead-foam insulation (R-24 max roof, R-9 max floor, R-8 max walls)
  - One-piece, seamless fiberglass front and rear caps
  - One-piece, seamless, crowned fiberglass roof
  - Fiberglass exterior walls with vinyl graphics
  - Entrance door with industry's largest travel view window
  - Electric-powered entrance step
  - Flush-mount LED marker lights
  - Third brake light
  - Lockable pass-through storage compartments with slam latches
  - (2) 6V AGM (220Ah) house batteries on slideout tray
  - 16.5 gal. propane tank (56 lb.)
  - LP quick-connect hookup
  - Heated holding tanks (12V pads)
  - Exterior utility center
  - Winterization drain system
  - Outside shower
  - Solar prep
  - Porch light

- Interior
  - 6-way power and swivel driver and passenger seats
  - Soft-touch, vinyl wrapped automotive dash
  - Tilt steering wheel
  - A/C and cruise control
  - Power front privacy shade with manual side privacy shades
  - 84 in. interior ceiling height with padded vinyl ceiling
  - LED lit hardwood fascia
  - Ball-bearing drawer guides
  - Hardwood cabinet doors and drawers
  - 21 cu.ft. residential refrigerator with ice and water in door
  - Furrion® all-in-one cooktop and oven
  - Residential-sized microwave
  - Powered roof vent in kitchen with wall switch
  - Decorative kitchen backsplash
  - 12V demand water pump
  - Digital antenna with signal booster
  - Water filtration system
  - Jayco-exclusive easy operation legless dinette table
  - 2-point lap safety belts in all designated seating locations
  - Auto-ignition ducted furnace - 30,000 BTU (29V, 31UL), 35,000-BTU (34B, 34G), (2)30,000 BTU (36A)
  - Furrion® electric fireplace (34B, 34G only)
  - High-intensity recessed LED ceiling lights
  - Blu-Ray™ player in living area
  - Cable TV hookup with RG-6 coax and video selector switch
  - Prep for satellite dish
  - Stainless steel bathroom sink
  - Porcelain toilet with foot flush
  - Shower with decorative surround, glass door, skylight and light
  - Powered roof vent in bathroom with wall switch
  - Walk-around King-sized bed with bedspread and nightstands
  - LED TV in bedroom
  - Bunks with industry-exclusive 300 lb. capacity each (36A)
  - Under-bed storage (select models)
  - Smoke alarm
  - Carbon monoxide detector

- Customer Value Package
  - JRIE® PLUS: Computer-balanced driveshaft, variable-rate jounce bumpers, heavy-duty front and rear stabilizer bars, SACHS shocks, Michelin® 22.5" tires
  - Sony® infotainment center Apple CarPlay® and Android Auto™
  - Automatic hydraulic leveling jacks
  - Backup and side-view cameras
  - Frameless windows
  - Onan® Marquis Gold Genset 5,500-watt generator with auto-gen start
  - 1,200-watt inverter
  - 50-amp electrical service
  - Electric patio awning with LED lights
  - Slideout cover awnings
  - Exterior entertainment center with outside speakers, LED TV mounted on swivel bracket and single-disc DVD/MP3 radio
  - LED living room TV
  - LED lit solid surface kitchen countertops with integrated stainless steel sink and sink covers
  - Removable driver/passenger cockpit table
  - Day/night roller shades
  - 15,000 BTU A/C unit with heat pump and second 13,500 BTU A/C unit

## Optional Equipment

OPTIONAL EQUIPMENT INSTALLED ON THIS VEHICLE  
BY MANUFACTURER

Base price	145,643.00
Addison	n/c
Oyster Bay Graphics	n/c
Package	n/c
USA Standards	n/c
Customer Value Package	11,250.00
Residential Refrigerator	n/c
Power Theater Seating	
Sofa	2,018.00
Front Overhead Bunk	2,993.00

UNIT TOTAL

161,904.00

DEALER INSTALLED OPTIONS

Manufacturer's Suggested Retail Price \$161,904.00

TOTAL AMOUNT DOES NOT INCLUDE STATE AND LOCAL TAXES OR LICENSE FEES. THE PRICE SHOWN ABOVE MAY OR MAY NOT BE REPRESENTATIVE OF THE ACTUAL SELLING PRICE OF SIMILAR RECREATIONAL VEHICLES IN YOUR AREA.

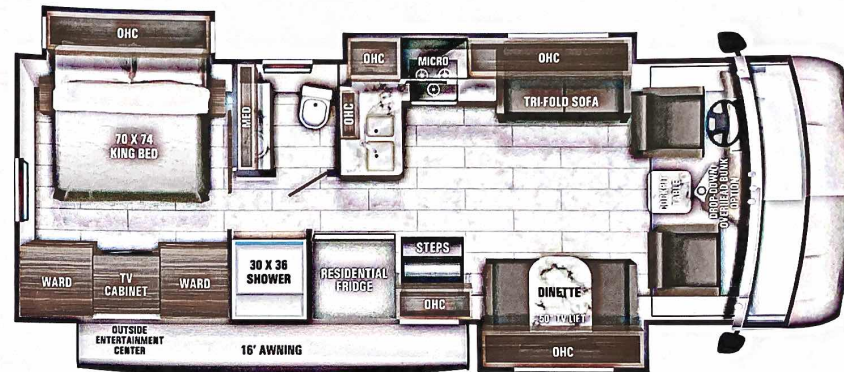

## DIMENSIONS

Exterior height:.....154.00"  
Exterior width:.....101.00"

## CAPACITIES

Fresh water tank (gals.):...72.00  
Gray water tank (gals.):...40.00  
Black water/toilet tank (gals.):...50.00  
Propane (lbs.):...56  
Propane (gals.):...13  
Water heater (gals.):...10.00

## TIRES

Tire size (front):.....235/80R22.5G  
Tire size (mid):.....  
Tire size (rear):.....235/80R22.5G

\*\*\*Some dimensions may be rounded and may vary from the actual dimensions\*\*\*

\*\*\*Weights may be estimated calculations and may vary from the actual weight

- refer to the vehicle weight labels for actual weights\*\*\*

Floorplans, features and specifications are subject to change without notice.

**2+3**  
YEAR | YEAR  
LIMITED | STRUCTURAL  
WARRANTY