



ENTEGRA

COACH®

Qwest



Serial #: 1J5LECBM3V1ZR8052
 Model: 25R QWEST MHC
 VIN#: W1X9N33Y0SN343781
 Model Year: 2027 Dealer Name: NATIONAL INDOOR RV CENTERS
 4640 NEXUS WAY
 NORTH LAS VEGAS, NV 89115

Manufacturer's Suggested Retail Price

\$257,318.00

TOTAL AMOUNT DOES NOT INCLUDE STATE AND LOCAL TAXES OR LICENSE FEES. THE PRICE SHOWN ABOVE MAY OR MAY NOT BE REPRESENTATIVE OF THE ACTUAL SELLING PRICE OF SIMILAR RECREATIONAL VEHICLES IN YOUR AREA.

Standard Equipment

- STANDARD EXTERIOR EQUIPMENT**
- Premium Mercedes-Benz® 4500 chassis with 170 in. wheelbase
 - GVWR: 12,250 lb.
 - 2.0L inline 4-cylinder Twin Turbo 211HP diesel engine with electronic fuel injection with 332 ft.-lb. torque and automatic transmission
 - 260-amp alternator
 - All-season tires - 215/65R16
 - Aluminum fms. 4-wheel anti-lock brakes
 - 5,000 lb. steel hitch receiver with dual connector and 7-pin plug
 - 12V chassis battery
 - 24 gal DEF tank
 - 24 gal DEF tank
 - TintShel® vacuum-bond laminated roof, floor and sidewalls
 - Bond-beam insulation (R-24 max roof, R-9 max floor)
 - One-piece, seamless, fiberglass roof
 - Premium SikaSeal® urethane sealant
 - Screened door with travel-view window and roll-up screen
 - Entrance powered entrance step with integrated hot-bus backup compartment
 - Aluminum side-hinged baggage doors with compression latches
 - Large rooftop exterior storage compartments
 - Prep for satellite dish
 - Cable TV hookup with RG-6 coax
 - Wincoport 2.0 Wi-Fi/4G antenna
 - 300W solar panel with dual controller
 - (2) 12V house batteries
 - LP quick-connect hookup
 - 16.5 gal propane tank (56 lb.)
 - LP quick-connect hookup
 - Exterior utility center
 - Exterior water pump
 - Ventilation clean system
 - Black tank flush
 - Outside shower
 - Water filtration system
 - Water filtration system
- CUSTOMER VALUE PACKAGE**
- Automatic bonded panoramic windows in front cap with power shade
 - 10.25 in. integrated Mercedes-Benz MBUX in front center with Apple CarPlay® and Android Auto™
 - Lippert™ 4000 series Fiberglass bonded windows
 - Electric stabilizer jacks
 - 2.000W inverter
 - Heated holding tanks (12V pads)
 - 2.000W inverter
 - 40 amp Corbin D Corrosion Plus diesel water heater
 - Backup and side-view cameras
 - Power, swivel, heated leatherette driver and passenger seats
 - Keyless entry

Optional Equipment

- STANDARD INTERIOR EQUIPMENT**
- Heated, remote-controlled, side-view mirrors
 - Tire pressure monitoring system (TPMS)
 - Smart lift steering wheelless charging
 - Active Distance Assist DISTROnIC®
 - Active lane keeping assist
 - Crosswind assist
 - Brake assist plus
 - Traffic sign assist
 - Attention assist
 - Emergency call system
 - Rain-sensing windshield wipers
 - LED night performance headlights
 - Power windows and door locks
 - Auxiliary start switch
 - LED interior lighting
 - Overhead bunk with 750 lb. capacity
 - Privacy curtain for cab area
 - Frontal Multiplex system - wall-mounted touchscreen and 80 in. app for ceiling height with added vinyl ceiling
 - High-intensity LED ceiling lights
 - Starazer Spirit XTR acrylic skylight with shade
 - Connoisseur, basic and top of drawers
 - Pantry with automatic lighting
 - Integrated day/night cassette shades
 - Maxxion Deluxe roof fan in living area with wall switch and remote
 - Entegra-exclusive, easy-operation legless dinette table
 - (2) 12V charged dinette with slow-sway pedestal legs (25L)
 - 12V USB charging station in dinette area
 - 2-point lap safety belts in all designated seating locations
 - Car seat belts (seated floorpans)
 - JBL audio system
 - 10 cu. ft. 12V refrigerator
 - Drop-in cooktop with one LP burner and one induction burner
 - Connection microwaves
 - Pressed stainless steel sink
 - Decorative kitchen backsplash (25L)
 - Queen-size power Murphy bed (25h)
 - USB port(s) in bedroom
 - Under-bed storage (select models)
 - Large wardrobes with automatic lighting
 - Shower with decorative surround and skylight
 - Aqua View® SHOWERMISER™ water management system
 - Porcelain toilet with foot flush (25L)
 - Porcelain roof vent in bathroom with wall switch
 - Carbon monoxide detector
 - Fire extinguisher

OPTIONAL EQUIPMENT INSTALLED ON THIS VEHICLE BY MANUFACTURER

Base price	241,800.00
CARLTON DECOR	N/C
GRENCROFT PAINT	30.00
USA STANDARDS	N/C
CUSTOMER VALUE PACKAGE	14,250.00
NO STARLINK	N/C
FRONT CAP CAB-OVER	N/C
STANDARD HOUSE BATTERY	N/C
FOLDING WINDSHIELD SUN SHADE	N/C
THEATER SEATING SOFA	488.00
	750.00

UNIT TOTAL

257,318.00

DEALER INSTALLED OPTIONS

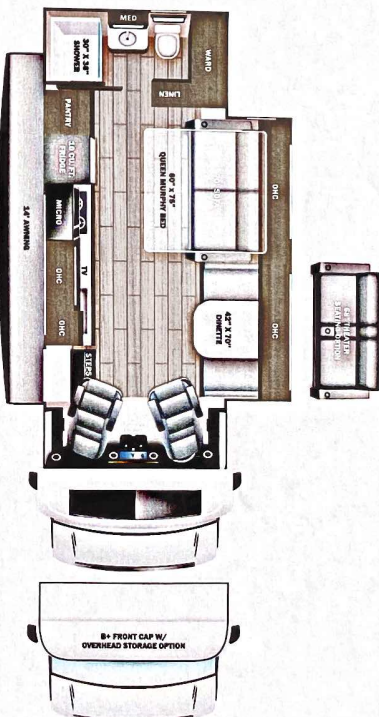

- DIMENSIONS**
- Exterior height:.....131.00"
 - Exterior width:.....102.00"

- CAPACITIES**
- Fresh water tank (gals.):.....45.00
 - Gray water tank (gals.):.....31.00
 - Black water/collet tank (gals):.....31.00
 - Propane (lbs.):.....56
 - Propane (gals.):.....13
 - Water heater (gals.):.....0.00

- TIRES**
- Tire size (front):.....LP215/85R16
 - Tire size (mid):.....LP215/85R16
 - Tire size (rear):.....LP215/85R16

Some dimensions may be rounded and may vary from the actual dimensions
 ***Weights may be estimated calculations and may vary from the actual weight
 - refer to the vehicle weight labels for actual weights***
 Floorplans, features and specifications are subject to change without notice.

