



14249

14249

# ENTEGRA

## COACH®

### Vision XL



Serial #: 1JSMFABU6V1UC8096  
 Model: 36C VISION XL MHA  
 VIN#: 1F66F5DN5T0A01356  
 Model Year: 2027 Dealer Name: NATIONAL INDOOR RV CENTERS  
 4640 NEXUS WAY  
 NORTH LAS VEGAS, NV 89115  
 USA

### Standard Equipment

THE FOLLOWING ITEMS ARE STANDARD ON THIS MODEL

- STANDARD EXTERIOR EQUIPMENT**
- Ford® F53 chassis
  - 36C VLN - 22,000 lb. (348, 34G), 24,000 lb. (36A, 36C)
  - GCWHN - 26,000 lb. (348, 34G), 30,000 lb. (36A, 36C)
  - 7.3L V-8 335 HP engine with 488 ft.-lb. torque
  - 30,000 BTU auto-ignition ducted furnace (31UL, 348, 34G)
  - 30,000 BTU auto-ignition ducted furnace (36A, 36C)
  - 2-point lap safety belts in all designated seating locations
  - 7-pin plug™, vacuum-bond laminated roof, floor and sidewalls
  - One-piece, seamless fiberglass front and rear cap
  - One-piece, seamless, crowned fiberglass roof
  - Roof ladder entry door
  - TV and FM Booster Antenna
  - (2) 6V AGM (220Ah) house batteries on slideout
  - JLP quick-connect hookup
  - Heated holding tanks (12V pads)
  - Outside shower
  - Hydraulic leveling jacks
  - Electric patio awning with LED lights
  - 7,000W generator with auto-gen start
  - 56 amp electrical service

### Optional Equipment

OPTIONAL EQUIPMENT INSTALLED ON THIS VEHICLE BY MANUFACTURER

- STANDARD INTERIOR EQUIPMENT**
- 120 in. panoramic windshield
  - Power front privacy shade with manual side privacy shades
  - Handwood cabinet doors and drawer fronts
  - 30,000 BTU auto-ignition ducted furnace (31UL, 348, 34G)
  - 30,000 BTU auto-ignition ducted furnace (36A, 36C)
  - 2-point lap safety belts in all designated seating locations
  - Residential refrigerator
  - Residential size microwave
  - USB port and wireless charging in nightstands
  - Smart TV in bedroom
  - Smart TV in living area
  - Smoke alarm
  - Carbon monoxide detector
  - Fire extinguisher
  - Integrated dry/night cassette shades

Base price	248,018.00
COASTAL DECOR	593.00
OHIO PAINT	17,993.00
USA STANDARDS	N/C
CUSTOMER VALUE PACKAGE	11,250.00
RESIDENTIAL REFRIGERATOR	N/C
NO WASHER/DRYER	N/C
SOFA - TRADITIONAL	N/C
FRONT OVERHEAD BUNK	3,293.00

UNIT TOTAL 281,147.00

DEALER INSTALLED OPTIONS

### Manufacturer's Suggested Retail Price

\$281,147.00

TOTAL AMOUNT DOES NOT INCLUDE STATE AND LOCAL TAXES OR LICENSE FEES. THE PRICE SHOWN ABOVE MAY OR MAY NOT BE REPRESENTATIVE OF THE ACTUAL SELLING PRICE OF SIMILAR RECREATIONAL VEHICLES IN YOUR AREA.

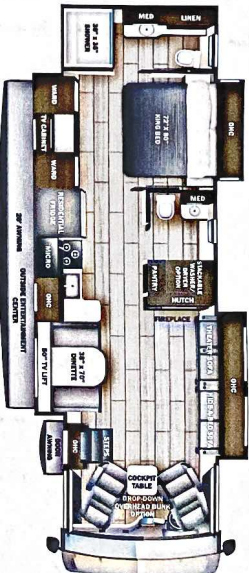

**DIMENSIONS**

Exterior height:.....154.00\*  
 Exterior width:.....101.00\*

**CAPACITIES**

Fresh water tank (gals.) :... 72.00  
 Gray water tank (gals.) :... 72.00  
 Black water/toilet tank (gals.) :... 72.00  
 Propane (lbs.) :... 56  
 Propane (gals.) :... 13  
 Water heater (gals.) :... 0.00

**TIRES**

Tire size (front) :... 255/80R22.5G  
 Tire size (mid) :...  
 Tire size (rear) :... 255/80R22.5G

\*\*\*Some dimensions may be rounded and may vary from the actual dimensions\*\*\*  
 \*\*\*Weights may be estimated calculations and may vary from the actual weight\*\*\*  
 - refer to the vehicle weight labels for actual weights\*\*\*  
 Floorplans, features and specifications are subject to change without notice.

