



Vision



Serial #: 1JSMEABP9V1AS8079
 Model: 29S VISION MHA
 VIN#: 1F65F5DN9T0A01274
 Model Year: 2027 Dealer Name: NATIONAL INDOOR RV CENTERS
 1350 HURRICANE SHOALS ROAD
 LAWRENCEVILLE, GA 30043
 USA

Manufacturer's Suggested Retail Price

\$227,096.00

TOTAL AMOUNT DOES NOT INCLUDE STATE AND LOCAL TAXES OR LICENSE FEES. THE PRICE SHOWN ABOVE MAY OR MAY NOT BE REPRESENTATIVE OF THE ACTUAL SELLING PRICE OF SIMILAR RECREATIONAL VEHICLES IN YOUR AREA.

Standard Equipment

THE FOLLOWING ITEMS ARE STANDARD ON THIS MODEL

STANDARD EXTERIOR EQUIPMENT

- Ford® F53 chassis
- GVWR - 18,000 lb.
- GCWR - 23,000 lb.
- 7.3L V-8 335 HP engine with 468 ft.-lb. torque
- 6-speed automatic TorqShift® transmission
- Catalytic converter theft deterrent
- 5,000 lb. rear hitch receiver with dual connector and 7-pin plug
- TuffShell™ vacuum-bond laminated roof, floor and sidewalls
- One-piece, seamless fiberglass front cap
- Hydraulic leveling jacks
- Frameless windows
- Travel-view entry door
- Roof ladder
- TV and FM Booster Antenna
- 7,000W generator
- (2) 6V AGM (220ah) house batteries on slideout tray
- 50-amp electrical service
- LP quick-connect hookup
- Heated holding tanks (12V pads)
- Outside shower
- Centralized water filtration system
- One-piece, seamless, crowned fiberglass roof

CUSTOMER VALUE PACKAGE

- E-Z Drive™: Computer-balanced driveshaft,
- Bilstein® steering stabilizer, jounce bumpers, heavy-duty front and rear stabilizer bars, SACHS shocks
- JBL® Exterior speakers, with Smart TV and Bluetooth® receiver
- Electric patio awning with LED lights
- Slideout topper awning(s)
- 1,200W inverter
- Sony® infotainment center with Apple CarPlay® and Android Auto™
- Backup and side-view cameras
- Smart TV in living area
- 200W solar panel with dual controller
- JBL® Audio system

STANDARD INTERIOR EQUIPMENT

- 120 in. panoramic windshield
- Power front privacy shade with manual side privacy shades
- Hardwood cabinet doors and drawer fronts
- 15,000 BTU A/C unit with heat pump and second 13,500 BTU A/C unit
- 30,000 BTU furnace
- 6 gal. gas/electric DSI water heater
- Legless dinette table
- 2-point lap safety belts in all designated seating locations
- 12V refrigerator
- All-in-one cooktop and oven
- Residential-size microwave
- Pop-up charging station in kitchen with 120V outlets and USB ports
- USB port and wireless charging in nightstands
- Bunks with 300 lb. capacity each (29F)
- Smoke alarm
- Carbon monoxide detector
- Fire extinguisher
- Blackout night roller shades

Optional Equipment

OPTIONAL EQUIPMENT INSTALLED ON THIS VEHICLE BY MANUFACTURER

Base price	194,168.00
COASTAL DECOR	593.00
CARLISLE GRAY PAINT	17,993.00
USA STANDARDS	n/c
CUSTOMER VALUE PACKAGE	9,923.00
BEDROOM TV	383.00
THEATER SEATING SOFA - TRADITIONAL	743.00
FRONT OVERHEAD BUNK	3,293.00

UNIT TOTAL **227,096.00**

DEALER INSTALLED OPTIONS

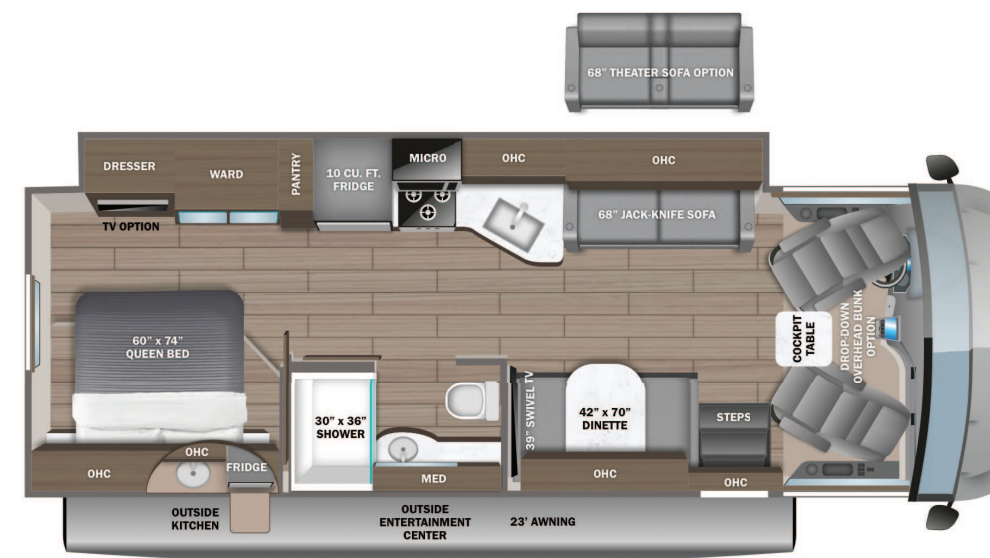

DIMENSIONS

Exterior height:.....149.00"
 Exterior width:.....101.00"

CAPACITIES

Fresh water tank (gals.):...72.00
 Gray water tank (gals.):...49.00
 Black water/toilet tank (gals.):.....50.00
 Propane (lbs.):.....56
 Propane (gals.):.....13
 Water heater (gals.):.....0.00

TIRES

Tire size (front):.....245/70R19.5G
 Tire size (mid):.....
 Tire size (rear):.....245/70R19.5G

Some dimensions may be rounded and may vary from the actual dimensions
 Weights may be estimated calculations and may vary from the actual weight - refer to the vehicle weight labels for actual weights
 Floorplans, features and specifications are subject to change without notice.



Document Identifier: MSPP SHEET