



# Vision



Serial #: 1JSMEABP7V1AS8050  
 Model: 29S VISION MHA  
 VIN#: 1F65F5DNXT0A00456  
 Model Year: 2027 Dealer Name: National Indoor RV Centers  
 1000 Aubrey Dr.  
 Lebanon, TN 37090  
 USA

## Manufacturer's Suggested Retail Price

\$226,501.00

TOTAL AMOUNT DOES NOT INCLUDE STATE AND LOCAL TAXES OR LICENSE FEES. THE PRICE SHOWN ABOVE MAY OR MAY NOT BE REPRESENTATIVE OF THE ACTUAL SELLING PRICE OF SIMILAR RECREATIONAL VEHICLES IN YOUR AREA.

### Standard Equipment

THE FOLLOWING ITEMS ARE STANDARD ON THIS MODEL

#### STANDARD EXTERIOR EQUIPMENT

- Ford® F53 chassis
- GVWR - 18,000 lb.
- GCWR - 23,000 lb.
- 7.3L V-8 335 HP engine with 468 ft.-lb. torque
- 6-speed automatic TorqShift® transmission
- Catalytic converter theft deterrent
- 5,000 lb. rear hitch receiver with dual connector and 7-pin plug
- TuffShell™ vacuum-bond laminated roof, floor and sidewalls
- One-piece, seamless fiberglass front cap
- Hydraulic leveling jacks
- Frameless windows
- Travel-view entry door
- Roof ladder
- TV and FM Booster Antenna
- 7,000W generator
- (2) 6V AGM (220ah) house batteries on slideout tray
- 50-amp electrical service
- LP quick-connect hookup
- Heated holding tanks (12V pads)
- Outside shower
- Centralized water filtration system
- One-piece, seamless, crowned fiberglass roof

#### CUSTOMER VALUE PACKAGE

- E-Z Drive™: Computer-balanced driveshaft,
- Bilstein® steering stabilizer, jounce bumpers, heavy-duty front and rear stabilizer bars, SACHS shocks
- JBL® Exterior speakers, with Smart TV and Bluetooth® receiver
- Electric patio awning with LED lights
- Slideout topper awning(s)
- 1,200W inverter
- Sony® infotainment center with Apple CarPlay® and Android Auto™
- Backup and side-view cameras
- Smart TV in living area
- 200W solar panel with dual controller
- JBL® Audio system

#### STANDARD INTERIOR EQUIPMENT

- 120 in. panoramic windshield
- Power front privacy shade with manual side privacy shades
- Hardwood cabinet doors and drawer fronts
- 15,000 BTU A/C unit with heat pump and second 13,500 BTU A/C unit
- 30,000 BTU furnace
- 6 gal. gas/electric DSI water heater
- Legless dinette table
- 2-point lap safety belts in all designated seating locations
- 12V refrigerator
- All-in-one cooktop and oven
- Residential-size microwave
- Pop-up charging station in kitchen with 120V outlets and USB ports
- USB port and wireless charging in nightstands
- Bunks with 300 lb. capacity each (29F)
- Smoke alarm
- Carbon monoxide detector
- Fire extinguisher
- Blackout night roller shades

### Optional Equipment

OPTIONAL EQUIPMENT INSTALLED ON THIS VEHICLE BY MANUFACTURER

Base price	194,168.00
STANDARDS(3AS)	n/c
OPTIONS(3AS)	32,333.00

UNIT TOTAL **226,501.00**

DEALER INSTALLED OPTIONS

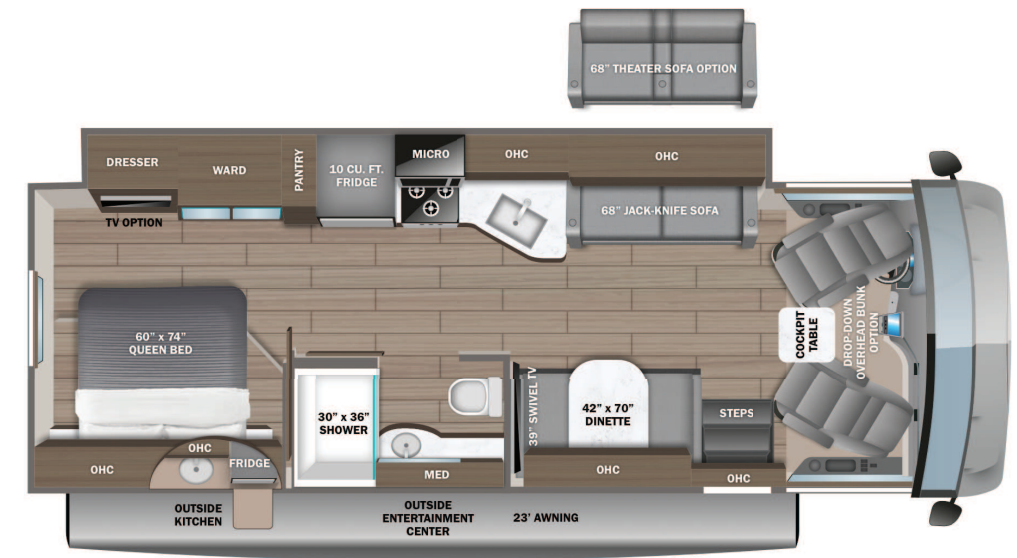

#### DIMENSIONS

Exterior height:.....149.00"  
 Exterior width:.....101.00"

#### CAPACITIES

Fresh water tank (gals.):...72.00  
 Gray water tank (gals.):...49.00  
 Black water/toilet tank (gals.):.....50.00  
 Propane (lbs.):.....56  
 Propane (gals.):.....13  
 Water heater (gals.):.....0.00

#### TIRES

Tire size (front):.....245/70R19.5G  
 Tire size (mid):.....  
 Tire size (rear):.....245/70R19.5G

\*\*\*Some dimensions may be rounded and may vary from the actual dimensions\*\*\*

\*\*\*Weights may be estimated calculations and may vary from the actual weight

- refer to the vehicle weight labels for actual weights\*\*\*

Floorplans, features and specifications are subject to change without notice.

