



# Centurion



Serial #: 1JSNECCV4V19D8051  
 Model: 45D CENTURION MHC  
 VIN#: 3ALHHL11TSWX3312  
 Model Year: 2027 Dealer Name: National Indoor RV Centers  
 1000 Aubrey Dr.  
 Lebanon, TN 37090  
 USA

## Manufacturer's Suggested Retail Price

\$741,025.00

TOTAL AMOUNT DOES NOT INCLUDE STATE AND LOCAL TAXES OR LICENSE FEES. THE PRICE SHOWN ABOVE MAY OR MAY NOT BE REPRESENTATIVE OF THE ACTUAL SELLING PRICE OF SIMILAR RECREATIONAL VEHICLES IN YOUR AREA.

### Standard Equipment

THE FOLLOWING ITEMS ARE STANDARD ON THIS MODEL

#### STANDARD EXTERIOR EQUIPMENT

- Freightliner® Cascadia 126 Day Cab
- Detroit® DD16 GEN 15.8L 600 HP engine with 1,850 torque at 1,120 RPM
- 12-speed overdrive automated manual transmission
- 12V 300 amp alternator
- 1,500W engine block heater
- Engine brake with global cruise control
- Detroit® safety assurance package with active break assist 5, adaptive cruise control, active side guard assist and lane departure warning system
- 18,000 lb. rating front axle
- 40,000 lb. rating rear axle
- All-wheel air disc brakes
- 2.85 rear axle ratio
- Michelin® 315/80R 22.5 in. tires (front) and 295/80R 22.5 in. tires (rear)
- Tire pressure monitoring system (TPMS) with sensors
- Equalizer™ EQ Hydraulic Smart Level System
- (3) 12V chassis batteries
- 120 gal. fuel tank
- 13 gal. DEF tank
- 30,000 lb. hitch with 7-pin plug
- 12,500W diesel generator with auto-gen start
- Victron 3,000W pure sine wave inverter with LED Screen
- (4) 6V 224 amp hour batteries
- 400W solar panels
- 50 amp power cord on electric powered reel
- Automatic transfer switch with surge protection
- (3) 15,000 BTU units with heat pumps
- Aqua-Hot® 450D hydronic water and heating system with engine preheat
- Aqua-Hot® heated basement storage
- Sani-Con® macerator holding tank dump system with manual gate valves and manual backup
- Black tank flush
- City and tank water filtration system
- Hot and cold water hook-up
- Water hose with electric reel
- Sikkens custom full-body paint
- Slideout awnings
- Frameless, dual-pane, tinted, safety-glass windows
- LED accent lights under all slideout rooms
- Electric-powered entrance step
- Keypad system for keyless entry
- Diamond Shield™ front protective film mask
- LED high and low beam headlights
- LED marker lights, turn lights, license plate light, third brake light, accent lights and docking lights
- Porch light and motion sensor security lights
- Winegard Connect 2.0 Wi-Fi/4G antenna
- Heated exterior utility center with tank monitoring system
- Carpeted, full pass-through storage compartments with lockable slam latch door
- Roof-mounted dual pitch integrated power patio awning with LED lights

#### STANDARD INTERIOR EQUIPMENT

- 360° HD digital camera system
- Powered Front Cap Privacy Shade
- Adjustable air-ride leather driver/passenger seats
- Firefly multiplex system with 10 in. VegaTouch touchscreen for complete integration of coach controls (mobile app available)
- 50 in. Smart TV in living room
- Soundbar in living room
- Premium leather furniture
- Hand-laid, porcelain tiled floors
- LED Interior Lighting
- Decorative ceiling feature with integrated accent lighting
- Manual solar day shades and blackout night shades
- Central vacuum system with in-wall dust pan
- Dual-pane, tinted, safety-glass windows
- Powered Flush Stepwell Cover
- Stainless steel residential refrigerator
- Recessed induction cooktop with solid surface covers
- Convection microwave with air fryer function
- Solid-surface countertops and dimmable LED accent lighting
- Hardwood cabinets and stiles throughout with dovetail construction
- Adjustable shelves
- Stainless steel sink
- Gel memory-foam mattress
- Solid-surface countertops and dimmable LED accent lighting
- Nightstands with solid-surface tops
- Smart TV in bedroom
- Solid-surface countertops with single sink and dimmable LED accent lighting
- Fiberglass pan, solid surface with tile insert
- Teakwood shower seat
- Aqua View SHOWERMISER™ water saving system
- Porcelain toilet in main bath
- Power exhaust vent fan in bathroom
- Stacked washer and dryer
- Carbon monoxide detector
- Smoke alarm

### Optional Equipment

OPTIONAL EQUIPMENT INSTALLED ON THIS VEHICLE BY MANUFACTURER

Base price	737,093.00
OXFORD DECOR	n/c
STONEWALL GRAY CABINERY	30.00
EXCLUDE DOVE WHITE FRONT OVERHEAD ACCENT WOOD	n/c
ALPI CHIARO TILE	1,493.00
VELOCITY BLUE PAINT	30.00
USA STANDARDS	n/c
2 DRAWER CABINET ILO	n/c
DISHWASHER	n/c
FREEZER W/TRAY	1,343.00
NON-BLACKOUT	n/c
SATELLITE PREP ONLY	n/c
STARLINK SATELLITE INTERNET SERVICE	893.00
FREE STANDING TABLE WITH 4 CHAIRS	143.00
HAB SOFA 60" P/S & THEATER SEATING 74" D/S	n/c

UNIT TOTAL **741,025.00**

DEALER INSTALLED OPTIONS

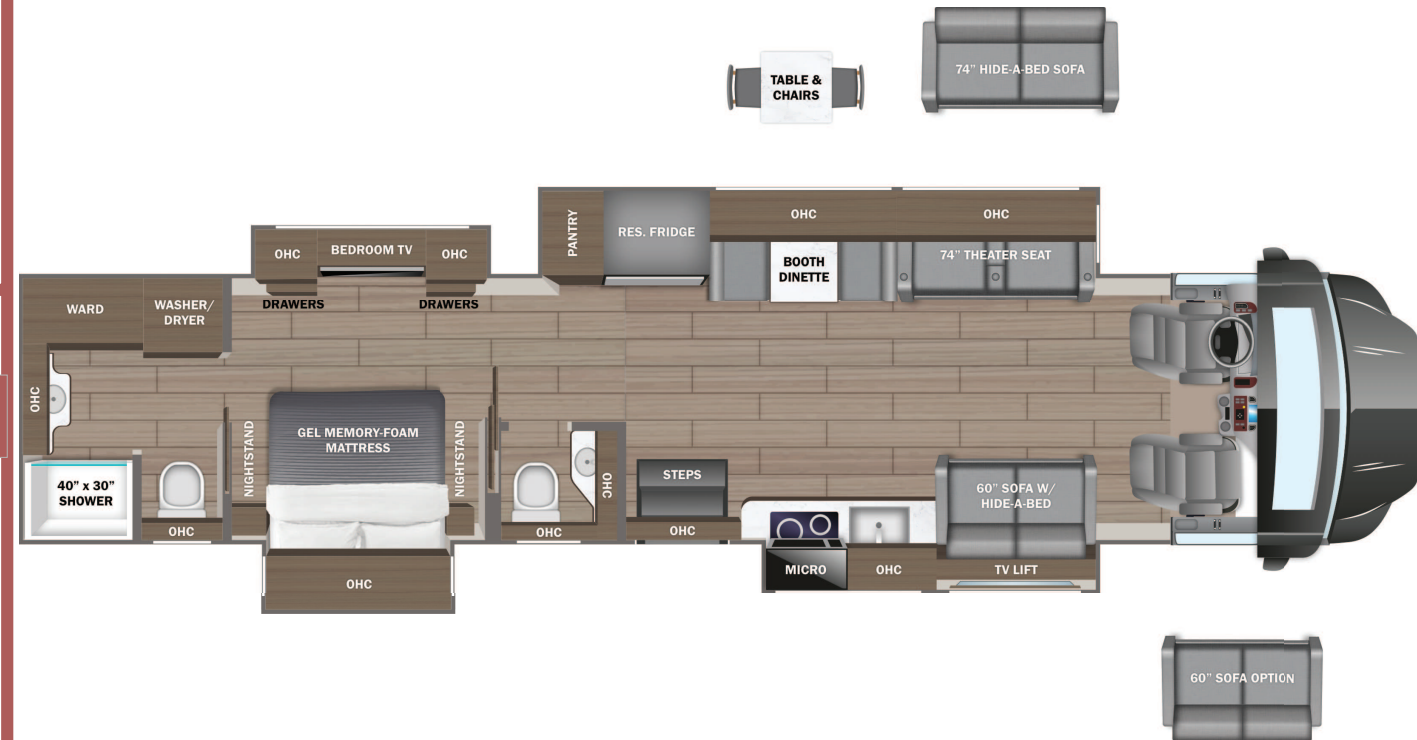

#### DIMENSIONS

Exterior height:.....157.00"  
 Exterior width:.....101.00"

#### CAPACITIES

Fresh water tank (gals.):..100.00  
 Gray water tank (gals.):.....0.00  
 Black water/toilet tank (gals.):.....40.00  
 Propane (lbs.):.....0  
 Propane (gals.):.....0  
 Water heater (gals.):.....0.00

#### TIRES

Tire size (front):.....315/80R22.5  
 Tire size (mid):.....295/80R22.5  
 Tire size (rear):.....295/80R22.5

\*\*\*Some dimensions may be rounded and may vary from the actual dimensions\*\*\*  
 \*\*\*Weights may be estimated calculations and may vary from the actual weight - refer to the vehicle weight labels for actual weights\*\*\*  
 Floorplans, features and specifications are subject to change without notice.

