

Melbourne Prestige



Serial #: 1UJLCBM7T1ZL4053
Model: 25LP MELBOURNE PRESTIGE MHC
VIN#: W1X9N33Y5SN336390
Model Year: 2026 Dealer Name: NATIONAL INDOOR RV CENTERS
11280 N SOLAR CANYON WAY
SURPRISE, AZ 85379
USA

Standard Equipment

THE FOLLOWING ITEMS ARE STANDARD ON THIS MODEL

- STANDARD EXTERIOR EQUIPMENT**
- Premium Mercedes-Benz® 4500 chassis with 170 in. wheelbase
 - GVWR- 12,125 lb.
 - GCWR- 15,250 lb.
 - 2.0L inline 4-cylinder Twin Turbo 211HP diesel engine with electronic fuel injection with 332 ft.-lb. torque
 - 9-speed automatic transmission
 - 280-amp alternator
 - All-season tires - 215/85R16
 - Aluminum rims
 - Front and rear disc, 4-wheel anti-lock brakes
 - 5,000 lb. rear hitch receiver with 7-pin plug
 - 12V chassis battery
 - 26.4 gal. fuel tank
 - 5.8 gal. DEF tank
 - StrongholdVBL™ roof, floor and sidewalls
 - Bead-foam insulation (R-24 max roof, R-9 max floor, R-5 max walls)
 - One-piece, seamless, fiberglass roof
 - Partial fiberglass rear cap
 - Premium Sikkens full-body paint
 - Chrome grille
 - Slideout awning(s)
 - Entrance door with travel-view window and roll-up screen
 - Electric-powered entrance step with integrated house battery compartment
 - Aluminum slide-hinged baggage doors with compression latches
 - Large rotocast exterior storage compartments
 - Third brake light
 - Prep for satellite dish
 - Cable TV hookup with RG-6 coax
 - Winegard 2.0 Wi-Fi/4G antenna
 - 4,000W LP generator
 - 200W solar panel with dual controller
 - (2) 12V house batteries
 - Transfer switch with reverse polarity protection
 - 30-amp electrical service
 - 16.5 gal. propane tank (56 lb.)
 - LP quick-connect hookup
 - Exterior utility center
 - Firefly SureLevel tank sensors
 - Winterization drain system
 - Black tank flush
 - Outside shower
 - 12V demand water pump
 - Water filtration system

- CUSTOMER VALUE PACKAGE**
- One-piece, seamless fiberglass front cap
 - Automotive-bonded panoramic window in front cap with power shade
 - 10.25 in. integrated Mercedes-Benz® MBUX infotainment center with Apple CarPlay® and Android Auto™
 - Lippert™ 4000 series frameless bonded windows
 - Hydraulic jacks
 - Girard® armless patio awning with LED light strip
 - 1,000W inverter
 - Heated holding tanks (12V pads)
 - Truma Combi D Comfort Plus diesel water heater and furnace
 - Backup and side-view cameras
 - Power, swivel, heated leatherette driver and passenger seats
 - Keyless cab entry

Optional Equipment

OPTIONAL EQUIPMENT INSTALLED ON THIS VEHICLE BY MANUFACTURER

- STANDARD INTERIOR EQUIPMENT**
- Heated, remote-controlled, side-view mirrors
 - Tire pressure monitoring system (TPMS)
 - Leather tilt steering wheel
 - Smartphone tray with wireless charging
 - Active Distance Assist DISTRONIC®
 - Active lane keeping assist
 - Crosswind assist
 - Hill start assist
 - Brake assist plus
 - Traffic sign assist
 - Attention assist
 - Breakdown management
 - Emergency call system
 - Rain-sensing windshield wipers
 - LED high performance headlights
 - Headlight assistant
 - Driver and passenger airbags
 - Power windows and door locks
 - Auxiliary start switch
 - Custom-rolled ABS surround in cab-over area
 - Overhead bunk with 750 lb. capacity
 - Privacy curtain for cab area
 - Firefly total coach control system with wall-mounted touchscreen and mobile app
 - 80 in. interior ceiling height with padded vinyl ceiling
 - High-intensity LED ceiling lights
 - Starazer Spirit XTR acrylic skylight with shade
 - Countertop, fascia and toe kick accent lights
 - Soft-close cabinet doors and drawers
 - Ball-bearing drawer guides
 - Pantry with automatic lighting
 - Jayco-exclusive, easy-operation legless dinette table (25RP)
 - U-shaped dinette with slow away pedestal legs (25LP)
 - Fold down dining table and chairs (25MP)
 - 12V USB charging station in dinette area
 - 2-point lap safety belts in all designated seating locations
 - Car seat tie-ins (select floorplans)
 - Integrated day/night cassette shades
 - 15,000 BTU A/C
 - Maxxian Deluxe roof fan in living area with wall switch and remote
 - LED HD TV in living area
 - JBL® audio system
 - 10 cu. ft. 12V refrigerator
 - Drop-in cooktop with one LP burner and one induction burner
 - Convection microwave
 - Pressed countertops
 - Recessed stainless steel sink
 - Decorative kitchen backsplash
 - King-size bed with bedspread (25LP)
 - Queen-size power Murphy bed (25MP, 25RP)
 - USB port(s) in bedroom
 - Under-bed storage (select models)
 - Bedroom TV prep (25LP)
 - Large wardrobes with automatic lighting
 - Aqua View® SHOWFRAMISER™ water management system
 - Stainless steel bathroom sink
 - Porcelain macerating toilet (25RP)
 - Porcelain toilet with foot flush (25MP, 25LP)
 - Powered roof vent in bathroom with wall switch
 - Smoke alarm
 - Carbon monoxide detector
 - Fire extinguisher

Base price	234,300.00
CARLTON DECOR	n/c
CRYSTAL VALLEY PAINT	30.00
CSA STANDARDS	293.00
CSA CHASSIS UPGRADE	5,550.00
CUSTOMER VALUE PACKAGE	7,050.00
FRONT CAP CAB-OVER	n/c
STANDARD HOUSE BATTERY	n/c
FOLDING WINDSHIELD SUN SHADE	488.00
DINETTE	n/c

UNIT TOTAL 247,711.00

DEALER INSTALLED OPTIONS

Manufacturer's Suggested Retail Price \$247,711.00

TOTAL AMOUNT DOES NOT INCLUDE STATE AND LOCAL TAXES OR LICENSE FEES. THE PRICE SHOWN ABOVE MAY OR MAY NOT BE REPRESENTATIVE OF THE ACTUAL SELLING PRICE OF SIMILAR RECREATIONAL VEHICLES IN YOUR AREA.

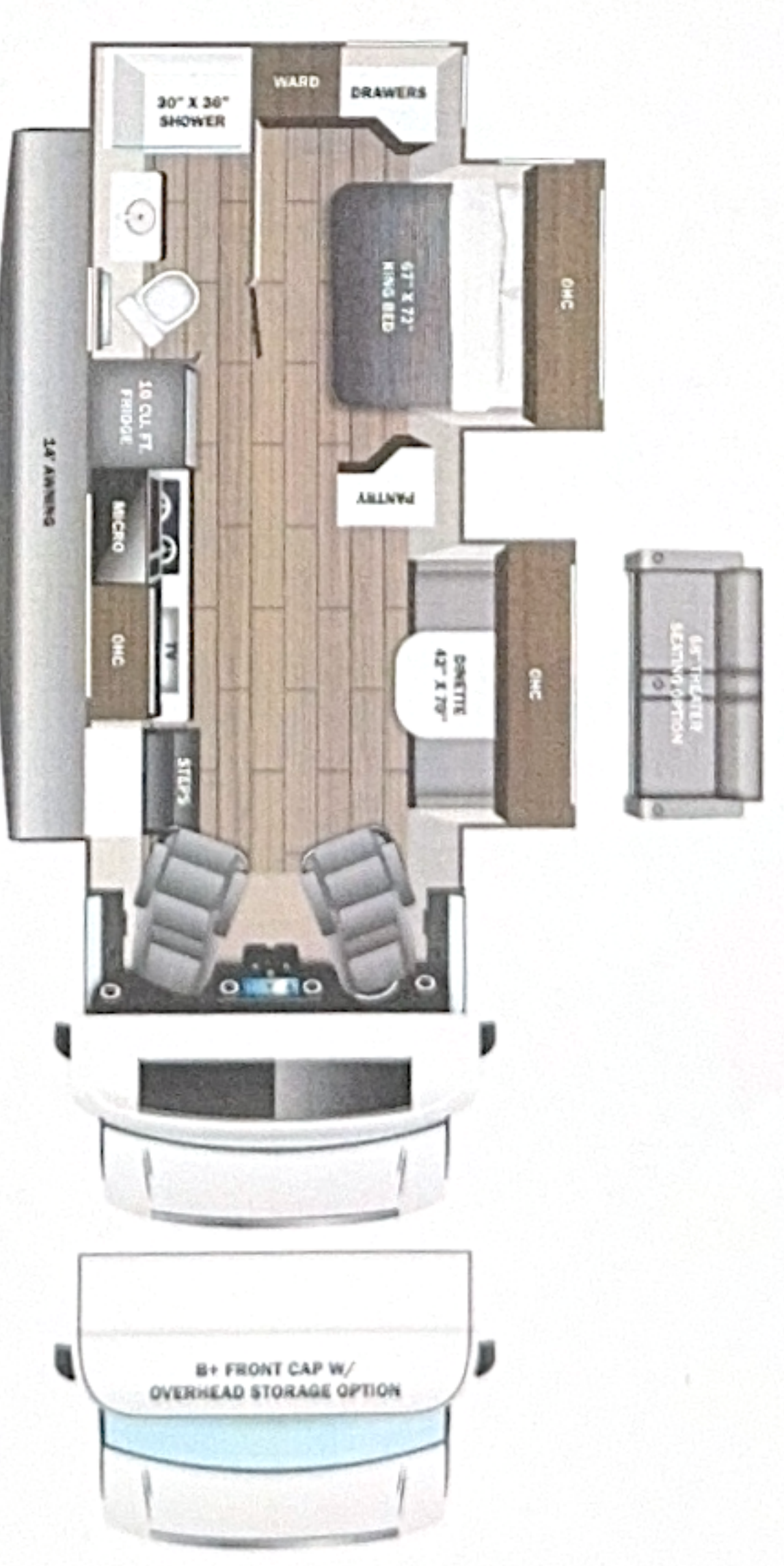

DIMENSIONS

Exterior height:.....131.00"
Exterior width:.....102.00"

CAPACITIES

Fresh water tank (gals.):...45.00
Gray water tank (gals.):...31.00
Black water/toilet tank (gals.):...31.00
Propane (lbs.):...56
Propane (gals.):...13
Water heater (gals.):...0.00

TIRES

Tire size (front):.....LT215/85R16
Tire size (mid):.....
Tire size (rear):.....LT215/85R16

Some dimensions may be rounded and may vary from the actual dimensions
***Weights may be estimated calculations and may vary from the actual weight
- refer to the vehicle weight labels for actual weights***
Floorplans, features and specifications are subject to change without notice.

