



Redhawk SE



Serial #: 1UULJCBL9T1G24156
Model: 22CF REDHAWK SE MHC
VIN#: 1FDWE3FN4TDD272249
Model Year: 2026 Dealer Name: NATIONAL INDOOR RV CENTERS

11280 N SOLAR CANYON WAY
SURPRISE, AZ 85379
USA

Standard Equipment

Optional Equipment

THE FOLLOWING ITEMS ARE STANDARD ON THIS MODEL

OPTIONAL EQUIPMENT INSTALLED ON THIS VEHICLE
BY MANUFACTURER

- STANDARD EXTERIOR EQUIPMENT
- Ford® E-350 chassis (22AF, 22CF, 22EF, 22TF)
 - GVWR - 12,500 lb. (22AF, 22CF, 22EF, 22TF)
 - GVWR - 18,500 lb. (22AF, 22CF, 22EF, 22TF)
 - Ford® E-450 chassis (29KF, 31FF)
 - GVWR - 14,500 lb. (29KF, 31FF)
 - GVWR - 22,000 lb. (29KF, 31FF)
 - 7.3L V-8 325 HP engine with 450 ft.-lb. torque
 - 6-speed TorqShift® series transmission with overdrive
 - 210-amp alternator
 - 5,000 lb. hitch with 500 lb. tongue capacity and 7-pin plug (22AF, 22CF, 22EF, 22TF, 29KF, 31FF)
 - Tire pressure monitoring system (TPMS)
 - Catalytic converter theft deterrent
 - Electronic stability control
 - Traction control
 - E-rated highway tires- LT225/75R16
 - 12V chassis battery
 - Power anti-lock brakes with power steering
 - Remote-controlled, side-view mirrors
 - StrongholdVBL™ roof, floor and sidewalls
 - Bead-foam insulation (R-24 max roof, R-9 max floor, R-5 max walls)
 - Tufflex™ PVC laminated roof
 - Aluminum running boards
 - Fiberglass exterior walls with vinyl graphics
 - Entrance door with industry's largest travel-view window
 - Electric-powered entrance step with integrated house battery compartment
 - Third brake light
 - Cable TV hookup with RG-6 coax
 - Digital antenna with signal booster
 - 4,000W generator
 - Solar prep
 - 12V house battery
 - Transfer switch with reverse polarity protection
 - 30-amp electrical service
 - 12.2 gal. propane tank (41 lb.)
 - LP quick-connect hookup
 - Exterior utility center
 - Winterization drain system
 - Outside shower
 - 12V demand water pump
 - Water filtration system

- STANDARD INTERIOR EQUIPMENT
- Hill start assist
 - Tilt steering wheel
 - Cruise control
 - Power windows and door locks
 - Securilock® anti-theft ignition
 - Auxiliary start switch
 - Driver and passenger airbags
 - Privacy curtain for cab area
 - Overhead bunk with 750 lb. capacity
 - 84 in. ceiling height
 - High-intensity, recessed LED ceiling lights
 - Ball-bearing drawer guides
 - Interior entrance door grab handle
 - Interior command center
 - Pleated blackout shades
 - 13,500 BTU ducted A/C
 - 30,000 BTU auto-ignition furnace
 - 6 gal. gas/electric DSI auto-ignition water heater
 - 42 in. x 76 in. U-shaped dinette (22AF, 22EF, 29KF)
 - Jayco-exclusive, easy-operation legless dinette table (22CF, 31FF)
 - 48 in. dinette bench with removable table (22TF)
 - 2-point lap safety belts in all designated seating locations
 - 10 cu. ft. 12V refrigerator
 - 2-burner cooktop with flush cover
 - Convection microwave oven
 - Stainless steel kitchen sink
 - Queen-size bed with bedsprad (22AF, 22CF, 29KF, 31FF)
 - (2) twin-size beds with filler cushion convert to king-size bed (22TF)
 - Large wardrobes (select models)
 - Bunks with industry-exclusive 300 lb. capacity each (31FF)
 - Shower with decorative ABS surround
 - Stainless steel bathroom sink
 - Toilet with foot flush
 - Smoke alarm
 - Carbon monoxide detector
 - Fire extinguisher

Base price	126,218.00
ASHBROOK DECOR	n/c
USA STANDARDS	n/c
26 FORD E35 12500 158*	
7.3L TD309	n/c
CUSTOMER VALUE PACKAGE	6,000.00
NO HYDRAULIC AUTO	
LEVELING JACKS	n/c
200W ROOF MOUNTED SOLAR	
PANEL W/2ND HOUSE BATTERY	893.00
STANDARD HOUSE BATTERY	n/c

UNIT TOTAL

133,111.00

DEALER INSTALLED OPTIONS

Manufacturer's Suggested Retail Price

\$133,111.00

TOTAL AMOUNT DOES NOT INCLUDE STATE AND LOCAL TAXES OR LICENSE FEES. THE PRICE SHOWN ABOVE MAY OR MAY NOT BE REPRESENTATIVE OF THE ACTUAL SELLING PRICE OF SIMILAR RECREATIONAL VEHICLES IN YOUR AREA.

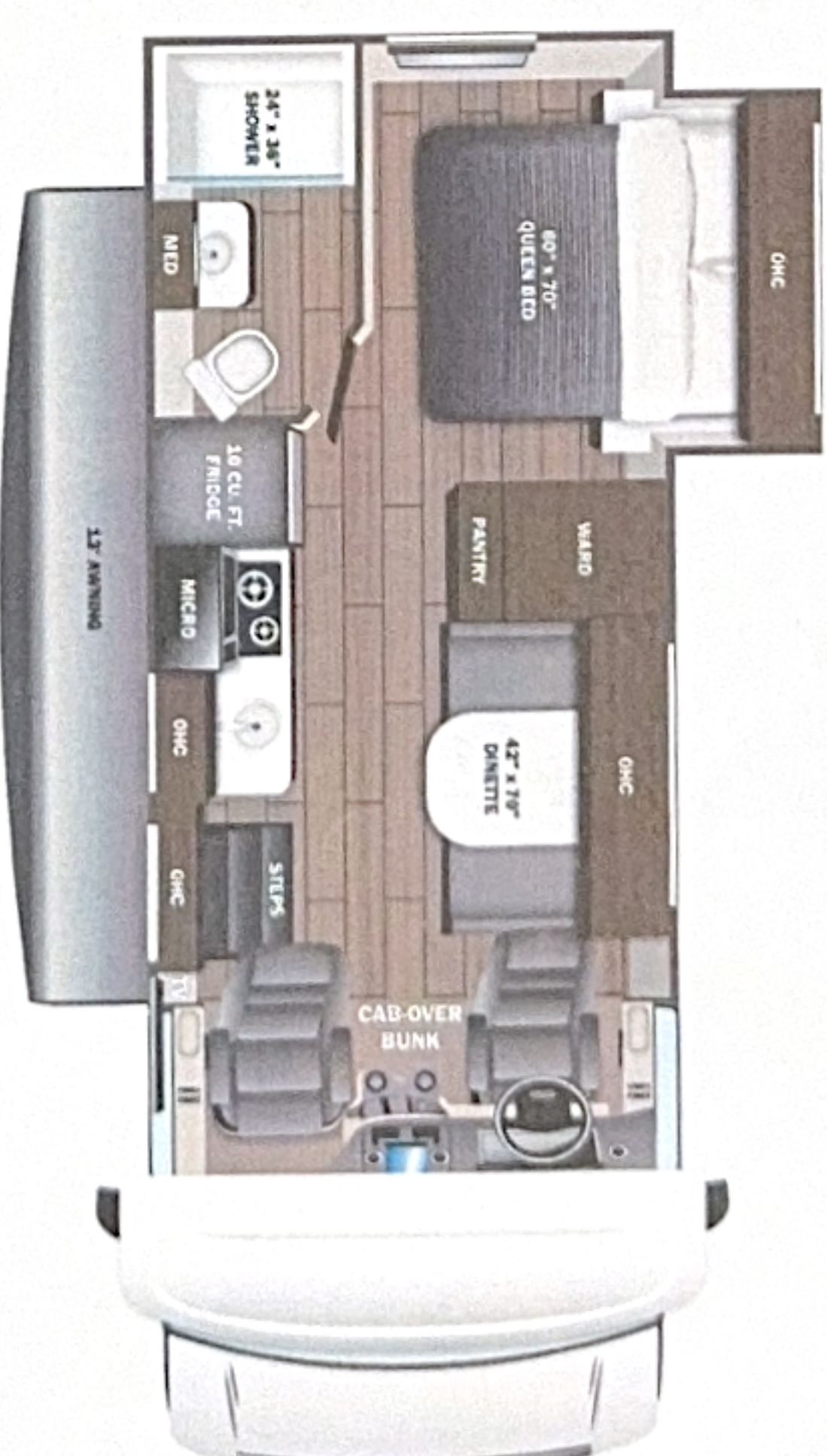

DIMENSIONS

Exterior height:.....138.00*
Exterior width:.....100.00*

CAPACITIES

Fresh water tank (gals.):.....43.50
Gray water tank (gals.):.....40.00
Black water/toilet tank (gals.):.....31.00
Propane (lbs.):.....41
Propane (gals.):.....9
Water heater (gals.):.....6.00

TIRES

Tire size (front):.....LT225/75R16E
Tire size (mid):.....
Tire size (rear):.....LT225/75R16E

Some dimensions may be rounded and may vary from the actual dimensions
Weights may be estimated calculations and may vary from the actual weight
- refer to the vehicle weight labels for actual weights***
Floorplans, features and specifications are subject to change without notice.

