



# INTEGRA

COACH®

## Accolade XT



Serial #: 1J5NECBT1T1JL8051  
Model: 35L ACCOLADE XT MHC  
VIN#: 1FDEF6LT0SDA04283  
Model Year: 2026 Dealer Name: National Indoor RV Centers

1000 Aubrey Dr.  
Lebanon, TN 37000  
USA

### Standard Equipment

### Optional Equipment

#### THE FOLLOWING ITEMS ARE STANDARD ON THIS MODEL

#### OPTIONAL EQUIPMENT INSTALLED ON THIS VEHICLE BY MANUFACTURER

STANDARD EXTERIOR EQUIPMENT	STANDARD INTERIOR EQUIPMENT	OPTIONAL EQUIPMENT
• Ford® F650 4X4 chassis (32U, 35L) • GVWR - 19,500 lb. (29T), 22,000 lb. (32U, 35L) • GVWR - 31,500 lb. (29T), 34,000 lb. (32U, 35L) • Block heater - 320 HP at 2,200 RPM and 850 ft. lb. torque at 1,800 RPM • 10-speed automatic transmission • All-terrain tires - 245/70R19.5 (225/70R19.5 on F550 chassis) • HiSpec® metal black aluminum rims • 12,000 lb. max suspension lift • Helwig® helper springs (29T) • Ford® AdvancedTrac® with HSC® (roll stability control) and trailer sway control • Dual fuel tanks (28.5 gal. and 40 gal.) • Dual chassis batteries (750 CCA 78 AH) • Insulated floor insulation (R-24 max roof, R-9 max floor) • One-piece, seamless, crowned fiberglass roof • Premium Sikens® full-body paint • 4000 series frameless bonded windows • Electric power windows • Electric-powered entrance steps • Slide-out cover awnings • Exterior entertainment center with JBL® outside speakers • Full pass-through storage compartments with lockable slam latch doors • Third brake light • Roof ladder • KING Jack® antenna • 6,000W diesel generator and auto-gen start • (2) 6V AGM house batteries • Transfer switch with reverse polarity protection • Power control panel • 24.5 gal. propane tank (83 lb.) • LP quick-connect hookup • Winterizing utility center • Outside shower and black tank flush • 12V demand water pump • 12V demand water pump • 2,000W pure sine wave inverter • 2000W pure sine wave inverter • Starting and charging system • Backup and side-view cameras • Two burner induction cooktop • 10 cu. ft. residential refrigerator (32U) • 18 cu. ft. residential refrigerator (32U, 35L) • Convection microwave oven	• Ford SYNC® 4 infotainment center with Apple® CarPlay™ and Android Auto™ • Audible line departure warning • Pre-Collision Assist® with automatic emergency braking (AEB) • LED Fog Crash Alert System™ • Driver and passenger airbags • Safety Canopy® system with roll-over side-curtain airbags • Remote keyless entry and perimeter anti-theft alarm • Quad dual-beam halogen headlights • RainX® wiper-activated headlights • Remote start • Individual leather pods • Individual leather reclining system (TPMS) (NA on F550 chassis) • Cruise control and door locks • Auxiliary battery disconnect • 8-way power driver seat • Tilt steering wheel • On-demand ABS surround in cab-over area • On-demand ABS surround in cab-over area • Privacy curtains for cab area • Finely Multiplex system - wall-mounted touchscreen and mobile app for total coach control • High-intensity, recessed LED ceiling lights • Integrated day/night cassette shades • Recessed panel hardwood cabinet doors and drawer fronts • Deluxe hidden cabinet hinges • Ball-bearing drawer guides • 30,000 BTU auto-suction furnace • 30,000 BTU auto-suction furnace • Elite® exclusive, easy-operation legless dinette table (32U, 35L) • 2-point lap safety belts in all designated seating locations • On-demand power windows (32U, 35L) • LED HD Smart TV in living area • JBL® audio system • LED-Lit solid-surface kitchen countertops with recessed pull-out countertop extension (sealed model) • Rear U-shaped power sofa converts to 80 in. x 96 in. bed (29T) • 12V surround King-size bed with bedspread and nightstands (32U, 35L) • LED HD Smart TV in bedroom (32U, 35L) • Electric fireplace in bedroom (35L) • Large wet/dry bags (select models) • Decorative shower surround with glass door, skylight and light • Ultra® Versa® SHOWERMAKER™ water management system • Macerating porcelain toilet • Powered roof vent in bathroom with wall switch • Smoke alarm • Fire extinguisher	Base price 34,155.00 COLD SPRING DECOR n/c ARCADIAN ASH CABINETRY 30.00 MIDNIGHT PAINT PACKAGE 30.00 USA STANDARDS n/c CUSTOMER VALUE PACKAGE 31,050.00 15 CU. FT. 12V REFRIGERATOR 443.00 NO WASH-ERDRYER n/c IN MOTION DISH SATELLITE SYSTEM n/c POWER THEATER SEATING 1,125.00 SOFA

UNIT TOTAL 374,228.00

DEALER INSTALLED OPTIONS

## Manufacturer's Suggested Retail Price

\$374,228.00

TOTAL AMOUNT DOES NOT INCLUDE STATE AND LOCAL TAXES OR LICENSE FEES. THE PRICE SHOWN ABOVE MAY OR MAY NOT BE REPRESENTATIVE OF THE ACTUAL SELLING PRICE OF SIMILAR RECREATIONAL VEHICLES IN YOUR AREA.

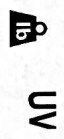
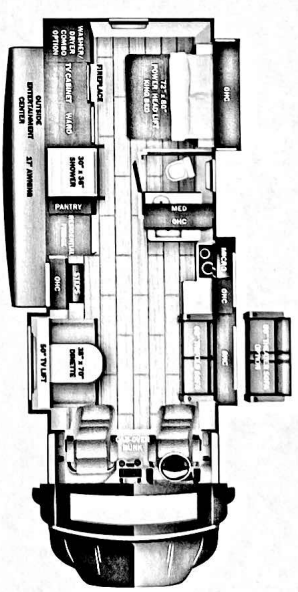

**DIMENSIONS**  
Exterior height: .....150.00"  
Exterior width: .....101.00"

**CAPACITIES**  
Fresh water tank (gals.): .....64.00  
Gray water tank (gals.): .....30.00  
Black water/collet tank (gals.): .....30.00  
Propane (lbs.): .....83  
Propane (gals.): .....19  
Water heater (gals.): .....0.00

**TIRES**  
Tire size (front): .....245/70R19.5G  
Tire size (mid): .....245/70R19.5G  
Tire size (rear): .....245/70R19.5G

\*\*\*Some dimensions may be rounded and may vary from the actual dimensions\*\*\*  
\*\*\*Weights may be estimated calculations and may vary from the actual weights\*\*\*  
- refer to the vehicle weight labels for actual weights\*\*\*  
Floorplans, features and specifications are subject to change without notice.