



Esteem



Serial #: 1JSLECBRXS1BV8201
Model: 29V ESTEEM MHC
VIN#: 1FDXE4FN6SDD25155
Model Year: 2025 Dealer Name: NATIONAL INDOOR RV CENTERS
1350 HURRICANE SHOALS ROAD
LAWRENCEVILLE, GA 30043
USA

Standard Equipment

Optional Equipment

THE FOLLOWING ITEMS ARE STANDARD ON THIS MODEL

OPTIONAL EQUIPMENT INSTALLED ON THIS VEHICLE BY MANUFACTURER

STANDARD EXTERIOR EQUIPMENT

- Ford® E-450 chassis
- GVWR - 14,500 lb.
- GCWR - 22,000 lb.
- 7.3L V-8 325 HP engine with 450 ft.-lb. torque
- 6-speed TorqShift® series transmission with overdrive
- 210-amp alternator
- Catalytic converter theft deterrent
- E-rated highway tires- LT225/75R16
- Tire pressure monitoring system (TPMS)
- Power anti-lock brakes with power steering
- 7,500 lb. hitch with 750 lb. tongue capacity and 7-pin plug
- 12V chassis battery
- 55 gal. fuel tank
- TuffShell™ vacuum-bond laminated roof, floor and sidewalls
- Bead-foam insulation (R-24 max roof, R-9 max floor, R-5 max walls)
- One-piece, seamless, fiberglass roof
- Fiberglass running boards
- Fiberglass side wings
- Fiberglass exterior walls with partial paint and vinyl graphics
- Remote keyless cab entry
- Entrance door with industry's largest travel-view window
- Electric-powered entrance step with integrated house battery compartment
- Slideout awning(s)
- Lockable storage compartments with slam latches
- Third brake light
- Roof ladder
- Prep for satellite dish
- Cable TV hookup with RG-6 coax
- Winegard 2.0 Wi-Fi/4G antenna
- 4,000W generator with auto-gen start
- 200W solar panel with dual controller and second house battery
- 12V house battery
- Transfer switch with reverse polarity protection
- 30-amp electrical service
- 16.5 gal. propane tank (56 lb.)
- LP quick-connect hookup
- Heated holding tanks (12V pads)
- Exterior utility center
- Winterization drain system
- Black tank flush
- Outside shower
- 12V demand water pump
- Water filtration system

STANDARD INTERIOR EQUIPMENT

- Swivel driver and passenger seats
- Tilt steering wheel
- Driver and passenger airbags
- Power windows and door locks
- Cruise control
- Hill start assist
- Electronic stability control
- Traction control
- Auxiliary start switch
- Custom-molded ABS surround in cab-over area
- Overhead bunk with 750 lb. capacity and safety net
- Privacy curtain for cab area
- BMPRO total coach control system with wall-mounted touchscreen and mobile app
- 84 in. interior ceiling height with padded vinyl ceiling
- High-intensity recessed LED ceiling lights
- LED-lit fascia
- Hardwood cabinet doors and drawer fronts
- Ball-bearing drawer guides
- Blackout night roller shades
- 15,000 BTU A/C with heat pump
- 30,000 BTU auto-ignition furnace
- 6 gal. gas/electric DSI auto-ignition water heater
- Entegra-exclusive, easy-operation legless dinette table
- 2-point lap safety belts in all designated seating locations
- Car seat tethers (select floorplans)
- LED HD Smart TV in living area
- JBL® audio system
- Smoke alarm
- Carbon monoxide detector
- Fire extinguisher
- 10 cu. ft. 12V refrigerator
- Furrion® all-in-one cooktop and oven
- Residential-size microwave
- Recessed stainless steel kitchen sink with solid-surface covers
- Flip-up countertop extension (select models)
- Decorative kitchen backsplash
- Pop-up charging station in kitchen with 120V outlets and USB ports
- Walk-around, queen-size bed with bedspread and nightstands (king size in 27U)
- USB port and wireless charging in nightstands
- Under-bed storage (select models)
- Large wardrobes
- Bunks with industry-exclusive 300 lb. capacity each (31F)
- Wall-mounted tablet holder in each bunk (31F)
- Shower with decorative surround, glass door, skylight and light
- Recessed stainless steel bathroom sink
- Porcelain toilet with foot flush
- Powered roof vent in bathroom with wall switch

CUSTOMER VALUE PACKAGE

- E-Z Drive™ Elite: Computer-balanced driveshaft, Koni® FSD shocks, heavy-duty rear stabilizer bar, standard front stabilizer bar, Hellwig® helper springs, rubber isolation mounts
- One-piece, seamless fiberglass front cap
- Automotive-bonded panoramic window in front cap with power shade
- Automatic hydraulic leveling jacks
- Frameless windows
- Electric patio awning with LED lights
- Exterior LED HD Smart TV with (2) high-output, marine-grade exterior speakers
- 1,000W inverter
- Chrome, heated, remote-controlled, side-view mirrors
- Sony® infotainment center with tilt/swivel, Apple® CarPlay and Android Auto™
- Backup and side-view cameras
- LED-lit, solid-surface kitchen countertops

Base price	180,293.00
OAKRIDGE DECOR	n/c
SILVER MIST PARTIAL PAINT	n/c
USA STANDARDS	n/c
25 FD E45 14500 158"	
7.3L WHITE SC10	n/c
CUSTOMER VALUE PACKAGE	9,000.00
BEDROOM TV	383.00
DUAL 13.5K ACS W/O HEAT PUMP	1,193.00
10 CU. FT. 12V REFRIGERATOR	n/c
NON-BLACKOUT	n/c
STEEL RIMS	n/c
STANDARD HOUSE BATTERY	n/c
FOLDING WINDSHIELD SUN SHADE	488.00
THEATER SEATING SOFA	743.00

UNIT TOTAL 192,100.00

DEALER INSTALLED OPTIONS

Manufacturer's Suggested Retail Price

\$192,100.00

TOTAL AMOUNT DOES NOT INCLUDE STATE AND LOCAL TAXES OR LICENSE FEES. THE PRICE SHOWN ABOVE MAY OR MAY NOT BE REPRESENTATIVE OF THE ACTUAL SELLING PRICE OF SIMILAR RECREATIONAL VEHICLES IN YOUR AREA.

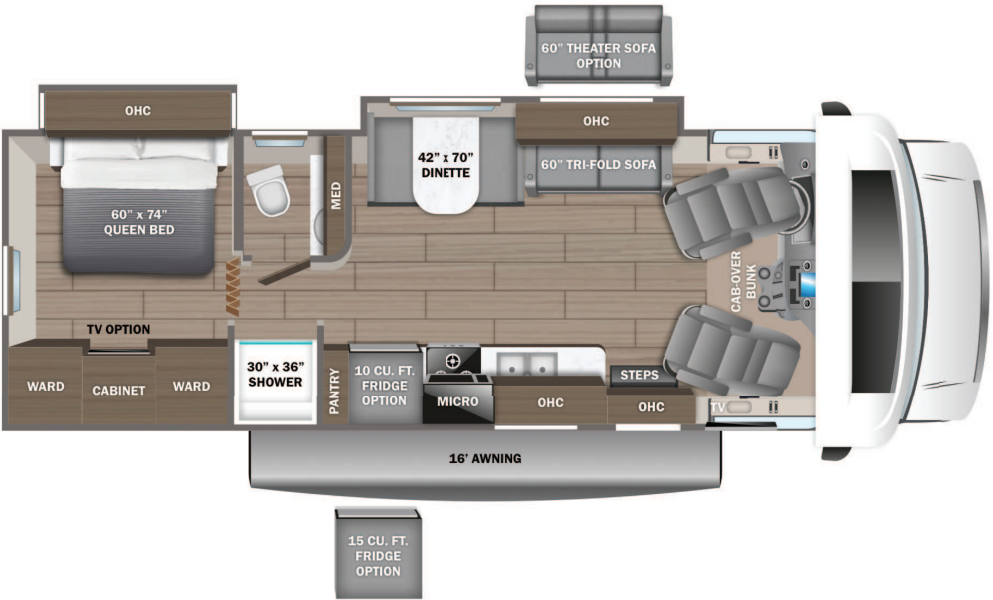

DIMENSIONS

Exterior height:.....140.00"
Exterior width:.....100.00"

CAPACITIES

Fresh water tank (gals.):...47.00
Gray water tank (gals.):...41.00
Black water/toilet tank (gals.):.....32.00
Propane (lbs.):.....56
Propane (gals.):.....13
Water heater (gals.):.....6.00

TIRES

Tire size (front):.....LT225/75R16E
Tire size (mid):.....
Tire size (rear):.....LT225/75R16E

Some dimensions may be rounded and may vary from the acutal dimensions
***Weights may be estimated calculations and may vary from the actual weight
- refer to the vehicle weight labels for actual weights***
Floorplans, features and specifications are subject to change without notice.